

United States Department of the Interior
National Park Service

National Register of Historic Places Registration Form

This form is for use in nominating or requesting determinations for individual properties and districts. See instructions in National Register Bulletin, *How to Complete the National Register of Historic Places Registration Form*. If any item does not apply to the property being documented, enter "N/A" for "not applicable." For functions, architectural classification, materials, and areas of significance, enter only categories and subcategories from the instructions. **Place additional certification comments, entries, and narrative items on continuation sheets if needed (NPS Form 10-900a).**

1. Name of Property

historic name Spencer Presbyterian Church

other names/site number Market Street Chapel

2. Location

street & number 408 Market Street

not for publication

city or town Spencer

vicinity

state West Virginia

code

WV

county

Roane

code

087

zip code

25276

3. State/Federal Agency Certification

As the designated authority under the National Historic Preservation Act, as amended,

I hereby certify that this X nomination request for determination of eligibility meets the documentation standards for registering properties in the National Register of Historic Places and meets the procedural and professional requirements set forth in 36 CFR Part 60.

In my opinion, the property X meets does not meet the National Register Criteria. I recommend that this property be considered significant at the following level(s) of significance:

 national statewide X local

Susan M. Pierce

Deputy SHPO

2/22/2016

Signature of certifying official/Title

Date

West Virginia State Historic Preservation Office

State or Federal agency/bureau or Tribal Government

In my opinion, the property meets does not meet the National Register criteria.

Signature of commenting official

Date

Title

State or Federal agency/bureau or Tribal Government

4. National Park Service Certification

I hereby certify that this property is:

 entered in the National Register

 determined eligible for the National Register

 determined not eligible for the National Register

 removed from the National Register

 other (explain:)

Signature of the Keeper

Date of Action

Spencer Presbyterian Church
Name of Property

Roane County, WV
County and State

5. Classification

Ownership of Property

(Check as many boxes as apply.)

<input checked="" type="checkbox"/>	private
<input type="checkbox"/>	public - Local
<input type="checkbox"/>	public - State
<input type="checkbox"/>	public - Federal

Category of Property

(Check only **one** box.)

<input checked="" type="checkbox"/>	building(s)
<input type="checkbox"/>	district
<input type="checkbox"/>	site
<input type="checkbox"/>	structure
<input type="checkbox"/>	object

Number of Resources within Property

(Do not include previously listed resources in the count.)

Contributing	Noncontributing	
1	1	buildings
0	0	sites
0	0	structures
0	0	objects
1	1	Total

Name of related multiple property listing

(Enter "N/A" if property is not part of a multiple property listing)

N/A

Number of contributing resources previously listed in the National Register

0

6. Function or Use

Historic Functions

(Enter categories from instructions.)

RELIGION: Religious facility

Current Functions

(Enter categories from instructions.)

WORK IN PROGRESS

7. Description

Architectural Classification

(Enter categories from instructions.)

LATE VICTORIAN: Gothic

Materials

(Enter categories from instructions.)

foundation: BRICK

walls: BRICK

roof: ASPHALT

other: SANDSTONE, WOOD

Spencer Presbyterian Church

Name of Property

Roane County, WV

County and State

Narrative Description

(Describe the historic and current physical appearance of the property. Explain contributing and noncontributing resources if necessary. Begin with a **summary paragraph** that briefly describes the general characteristics of the property, such as its location, setting, size, and significant features.)

Summary Paragraph

See continuation sheets.

Narrative Description

See continuation sheets.

Spencer Presbyterian Church

Name of Property

Roane County, WV

County and State

8. Statement of Significance

Applicable National Register Criteria

(Mark "x" in one or more boxes for the criteria qualifying the property for National Register listing.)

- ☐ A Property is associated with events that have made a significant contribution to the broad patterns of our history.
- ☐ B Property is associated with the lives of persons significant in our past.
- ☒ C Property embodies the distinctive characteristics of a type, period, or method of construction or represents the work of a master, or possesses high artistic values, or represents a significant and distinguishable entity whose components lack individual distinction.
- ☐ D Property has yielded, or is likely to yield, information important in prehistory or history.

Criteria Considerations

(Mark "x" in all the boxes that apply.)

Property is:

- | | |
|-------------------------------------|--|
| <input checked="" type="checkbox"/> | A Owned by a religious institution or used for religious purposes. |
| <input type="checkbox"/> | B removed from its original location. |
| <input type="checkbox"/> | C a birthplace or grave. |
| <input type="checkbox"/> | D a cemetery. |
| <input type="checkbox"/> | E a reconstructed building, object, or structure. |
| <input type="checkbox"/> | F a commemorative property. |
| <input type="checkbox"/> | G less than 50 years old or achieving significance within the past 50 years. |

Areas of Significance

(Enter categories from instructions.)

ARCHITECTURE

Period of Significance

1903

Significant Dates

1903

Significant Person

(Complete only if Criterion B is marked above.)

N/A

Cultural Affiliation

N/A

Architect/Builder

Unknown

Period of Significance (justification)

See continuation sheets.

Criteria Considerations (explanation, if necessary)

See continuation sheets.

Spencer Presbyterian Church

Name of Property

Roane County, WV

County and State

Statement of Significance Summary Paragraph (Provide a summary paragraph that includes level of significance and applicable criteria.)

See continuation sheets.

Narrative Statement of Significance (Provide at least **one** paragraph for each area of significance.)

See continuation sheets.

Developmental history/additional historic context information (if appropriate)

See continuation sheets.

Spencer Presbyterian Church
Name of Property

Roane County, WV
County and State

9. Major Bibliographical References

Bibliography (Cite the books, articles, and other sources used in preparing this form.)

See continuation sheets.

Previous documentation on file (NPS):

☐ preliminary determination of individual listing (36 CFR 67 has been requested)
☐ previously listed in the National Register
☐ previously determined eligible by the National Register
☐ designated a National Historic Landmark
☐ recorded by Historic American Buildings Survey # _____
☐ recorded by Historic American Engineering Record # _____
☐ recorded by Historic American Landscape Survey # _____

Primary location of additional data:

☒ State Historic Preservation Office
☐ Other State agency
☐ Federal agency
☐ Local government
☐ University
☐ Other

Name of repository: _____

Historic Resources Survey Number (if assigned): _____

10. Geographical Data

Acreage of Property .25

(Do not include previously listed resource acreage.)

UTM References

(Place additional UTM references on a continuation sheet.)

1 17 469430 4294701
Zone Easting Northing

2 _____
Zone Easting Northing

3 _____
Zone Easting Northing

4 _____
Zone Easting Northing

Verbal Boundary Description (Describe the boundaries of the property.)

See continuation sheets.

Boundary Justification (Explain why the boundaries were selected.)

See continuation sheets.

Spencer Presbyterian Church

Name of Property

Roane County, WV

County and State

11. Form Prepared By

name/title Andrew Lore, Historian

organization WV SHPO

date 11/23/2015

street & number 1900 Kanawha Blvd E.

telephone 304-558-0240

city or town Charleston

state WV

zip code 25305

e-mail _____

Photographs:

Submit clear and descriptive photographs. The size of each image must be 1600x1200 pixels at 300 ppi (pixels per inch) or larger. Key all photographs to the sketch map.

See continuation sheets.

Paperwork Reduction Act Statement: This information is being collected for applications to the National Register of Historic Places to nominate properties for listing or determine eligibility for listing, to list properties, and to amend existing listings. Response to this request is required to obtain a benefit in accordance with the National Historic Preservation Act, as amended (16 U.S.C.460 et seq.).

Estimated Burden Statement: Public reporting burden for this form is estimated to average 18 hours per response including time for reviewing instructions, gathering and maintaining data, and completing and reviewing the form. Direct comments regarding this burden estimate or any aspect of this form to the Office of Planning and Performance Management, U.S. Dept. of the Interior, 1849 C. Street, NW, Washington, DC.

United States Department of the Interior
National Park Service

National Register of Historic Places
Continuation Sheet

Spencer Presbyterian Church
Name of Property
Roane County, WV
County and State
N/A
Name of multiple listing (if applicable)

Section number 7 Page 1

Summary Paragraph

The Spencer Presbyterian Church, locally known as the Market Street Chapel, is located in downtown Spencer, Roane County. Built in 1903, the church sits at an elevation of approximately ten feet above Market Street, which runs through the town of Spencer. With poured concrete steps leading to the entrance, the church is a fine example of Late Victorian Gothic architecture in Spencer, with Gothic pointed arch windows, pristine stained glass windows, and a 40-foot bell tower.

Narrative Description

Located in the commercial and residential area of downtown Spencer, the Spencer Presbyterian Church is a significant local example of Late Victorian Gothic Revival style. The church, which sits approximately ten feet above street level, is of brick construction and a poured concrete sidewalk outlines the church's perimeter. The front gabled façade (south elevation) of the building protrudes slightly towards Market Street. To the east of the front façade is a 40-foot steeple, which houses the double-door entrance of the church at its base, as well as the church's bell; the steeple is topped with a cross. The windows on the front façade, as well as the entry door, are designed in the Gothic pointed arch style. The transom of the door is filled with stained glass, giving the name of the church and its construction date: 1903. Inlaid on the replacement mahogany front doors are stained glass windows featuring white doves. On the projecting front façade, as well as the steeple, there are minor pointed arch windows that feature stained glass: on the left side of the façade (southwest elevation), and the right side of the steeple (southeast elevation).

On both front gabled side elevations of the church (east and west elevations), there are three stained glass Gothic pointed arch windows, with the center window being the most prominent. All of the stained glass in the church contains religious imagery, with the main, three-paneled windows on either side façade dedicated to congregants and prominent members of the church. The rear façade (north elevation), which is detached from the modern education building built in the 1950s, has a rear entrance on either side. There are two Gothic arch windows present on both sides of the protruding bay that surrounds the altar internally. In the center of the rear elevation, there is an ocular window frame; however, the window is no longer present, but efforts are being made to restore it. The asphalt, fishscale shingle roof of the church is a replacement, which was completed a couple of years ago during its restoration.

The 1950's education building, which was previously attached to the rear of the church, has not been used in nearly three decades, and many of the building's elements have been removed. The building is of concrete block construction and does not have a roof; the supporting steel beams are exposed. The windows of the education building have had their panes either removed or broken. The floor is poured concrete, which had been covered in vinyl tile during its use.

The church foyer, which also houses the bell tower, has had its floor replaced with a modern slate tile. To the left of the foyer, a hallway runs the remaining width of the church, with a massive, three-paned Gothic pointed arch window on the left. At the end of the hallway, there are remnants of a brick fireplace and

United States Department of the Interior
National Park Service

National Register of Historic Places
Continuation Sheet

Spencer Presbyterian Church
Name of Property
Roane County, WV
County and State
N/A
Name of multiple listing (if applicable)

Section number 7 Page 2

mantle. The hallway, at one time, was separated from the main sanctuary by a folding partition, which has been removed to open-up the floor plan, but does not affect the building's integrity. Fragments of the original walnut-stained, oak wainscoting can still be seen in certain areas, and restoration work is being undertaken to recreate the paneling. The ceiling of the church runs parallel with the roof line, just dropped slightly. The original walnut-stained tongue and groove panels are still present in the church, aiding the church sanctuary's acoustics. The concrete floor of the church has been covered with modern gray carpet. There are three windows missing in the church: the coin window above the altar mentioned previously, one to the left of the altar, and one above the backdoor, but restoration work is being completed in order to fashion windows that are sympathetic to the church's style. All of the remaining stained glass windows are original to the church.

United States Department of the Interior
National Park Service

National Register of Historic Places
Continuation Sheet

Spencer Presbyterian Church
Name of Property
Roane County, WV
County and State
N/A
Name of multiple listing (if applicable)

Section number 8 Page 1

STATEMENT OF SIGNIFICANCE

The Spencer Presbyterian Church is eligible for listing in the National Register of Historic Places under Criterion C: Architecture, as a fine local example of the Late Victorian Gothic style. The church also meets Criterion Consideration A: Religious Properties, as its significance is directly related to its architecture. The church was built in 1903, which coincides with its period of significance. In an area in which many churches were of wood frame construction and covered in weatherboard or other wood and vinyl siding, the Spencer Presbyterian Church was the area's first example of high-style Victorian Gothic architecture.

HISTORY

The Spencer Presbyterian Church, by the earliest known records, was formed on September 22, 1874.¹ The church was organized by a visiting preacher.² While Presbyterianism may have existed in Roane County prior to that time, little is known about its activities in the region. In the early 19th century, Presbyterians traveled throughout Roane County and established Sunday Schools, but there was still not a unifying, central house of worship in the county. Before the advent of the Spencer Presbyterian Church, there was a small Presbyterian Church established on County Route 36 in Roxalana, but its use was short-lived.

When the founding families of the Spencer Presbyterian Church—the Adams, Baileys, Gibsons, Smiths, Stones, and Walkers—met in 1874, the first item on their agenda was the construction of a church so that Presbyterians in the area could worship together as a community. The new church was a white frame structure, built on the same Market Street lot where the current church presently sits. The deed to the church was executed by Mr. and Mrs. Clay C. Smith and Mr. and Mrs. Benjamin D. Williams. The deed to the lot and the original building was given to the elected Trustees of the Church—Mr. H.F. Gibson, Dr. John B. Thompson, Dr. A.G. Bailey, Mr. A.B. Wells, and Mr. Clay Smith. In 1901, three more men were elected to the board of trustees: Mr. J.B. Casto, Mr. A.S. Heck, and Mr. G.P. Stone.³ A.S. Heck refers to Albert S. Heck, a prominent oil producer in the area, whose Neoclassical home in Spencer was listed on the National Register of Historic Places in 1999.⁴

From the date of its formation until 1930, the Spencer Presbyterian Church was affiliated with the Presbyterian Church of the United States of America, or the Northern Presbyterian branch of Presbyterianism. Until 1930, Roane County was included in the bounds of the Petersburg Presbytery, and

1. Kenneth King, "Presbyterian Church Founded Here 1874," *Centennial Newspapers: 1856-1956*, 285.

2. William H. Bishop, *History of Roane County West Virginia: From the Time of Its Exploration to A.D. 1927* (Spencer: West Virginia Historical Society, 1927), 355.

3. King, 285.

4. The Albert S. Heck, or McIntosh Mansion, is listed on the National Register as #99000289.

United States Department of the Interior
National Park Service

National Register of Historic Places
Continuation Sheet

Spencer Presbyterian Church
Name of Property
Roane County, WV
County and State
N/A
Name of multiple listing (if applicable)

Section number 8 Page 2

many of the church founders came from Ohio, Pennsylvania, and other northern states, effectively bringing Presbyterianism to a region that had been Methodist and Baptist predominately.⁵ For unknown reasons, the Spencer Presbyterian Church was dissolved in 1930, but the church reopened in 1952. Shortly after being organized into a Southern Presbyterian Church in 1954, the congregation endeavored to add to the culture and education of community, thus building an educational building addition to the back of the church.⁶

In 1971, after the cave-in of the back wall, the congregation built a new church outside of town on County Route 14 North, which opened in 1975. The building was then used as the Early Childhood Education Center for thirteen years, serving over 225 preschoolers in two shifts.⁷ In September 1989, the building began to house the Building Blocks Child Development Center. Abandoned in the 1990s, the building was left vacant for an extended period of time, slated for demolition, and eventually purchased by its current owners, who plan to restore the property, giving the community a multi-purpose facility.

SIGNIFICANCE

The church's congregation first worshipped in the present brick building on November 29, 1903.⁸ The church's brick exterior made it very different from any other houses of worship in the area during that time period. While many churches in the county used a wooden frame structure with weatherboard, clapboard, and later aluminum/vinyl siding, the Spencer Presbyterian Church's prominent members built a locally beautiful church, using brick and incorporating high-style elements of Gothic architecture, making the building unique in Spencer.

The church is a significant local example of Late Victorian Gothic architecture with massive Gothic pointed arch windows throughout. As the Gothic Revival movement influenced American architecture in the late 19th and early 20th century, congregations began to build churches more aligned with English medieval architecture, seeing it as "the most proper" style.⁹ Most Victorian-style buildings are defined by their asymmetrical facades and steeply pitched roofs.¹⁰ In addition to its other Gothic elements, the Spencer

5. King, 285.

6. King, 286.

7. Roane County Family History Committee, *Roane County, West Virginia Family History* (Marceline: Walsworth Publishing, 1990), 30-31.

8. King, 285. Although King states that the church was constructed in 1903, as do the current owners, Bishop writes on page 355 that the brick structure was built between 1907-1908.

9. National Park Service, "Religious Architecture," accessed November 30, 2015, <http://www.nps.gov/nr/travel/charleston/architecture.htm>

10. Virginia and Lee McAlester, *A Field Guide to American Houses* (New York: Alfred A. Knopf Inc., 2002), 239.

United States Department of the Interior
National Park Service

National Register of Historic Places
Continuation Sheet

Spencer Presbyterian Church
Name of Property
Roane County, WV
County and State
N/A
Name of multiple listing (if applicable)

Section number 8 Page 3

Presbyterian Church features a cross-topped steeple, which is a common element in the Late Victorian Gothic style.¹¹

The WV SHPO has nine other Roane County churches documented. Churches, such as the Amma Methodist Church (RO-0006-0001), the Pleasant Hills Church (RO-0009-0002), the Wallback United Methodist Church (RO-0009-0003), and the Rolling Hills Church (RO-0011) are wood frame Folk Victorian design, covered in weatherboard and/or clapboard.¹² The Newton Baptist Church (RO-0010-0001), the Boggs Fork Church (RO-0019), and the Mount Welcome Union Church (RO-0025) are also wood frame Folk Victorian buildings, clad in aluminum or vinyl siding. The First Baptist Church (RO-0005-0075) is a modern brick structure built in the 1950s, while the Newton United Methodist Church (RO-0010-0006) has a stucco and weatherboard exterior, following the same design as the other Folk Victorian churches in the area. Differing from the other Roane County churches documented, the Spencer Presbyterian Church embodies more high-style design elements of Gothic architecture, most notably its stained glass windows.

In the same area of Spencer, there are two other churches, both Gothic style with crenelated towers defining the front facade. The St. John's Methodist Episcopal Church on Church Street was founded near the end of the Civil War and a small church was built where the current building stands; the present brick structure was completed in 1915.¹³ Like the Spencer Presbyterian Church, the Methodist Episcopal Church features Gothic elements, such as its arches and stained glass windows. The Memorial Methodist Protestant Church, approximately five hundred feet southwest of the Spencer Presbyterian Church, also features Gothic elements with its arches and stained glass windows. The Methodist Protestant Church first housed its congregation in a small church house in 1892, but the current building was completed in 1927.¹⁴ Given that both of the Methodist churches in Spencer were completed after 1903, not only is the Spencer Presbyterian Church architecturally significant to the area, but it is also the oldest church in Spencer.

The stained glass windows in the Spencer Presbyterian Church give the building its significant elements. Once slated for auction, because of the church's impending demolition, the majority of the church's original stained glass was recovered, with a local artist providing restoration work and sympathetic matches for those windows that were not found. Unlike the other stained glass in nearby St. John's Methodist and Memorial Methodist, the windows in the Spencer Presbyterian Church are filled with symbolic imagery, giving a more intimate and personal feeling than the geometric patterns of the other two. It is the artistic renditions and craftsmanship of the Spencer Presbyterian Church's stained glass windows that most distinguishes it from its surrounding churches.

11. National Park Service, "Religious Architecture."

12. The numbers in parentheses denote the WV SHPO numbers associated with each property.

13. Bishop, 353-354.

14. Bishop, 358.

United States Department of the Interior
National Park Service

National Register of Historic Places
Continuation Sheet

Spencer Presbyterian Church
Name of Property
Roane County, WV
County and State
N/A
Name of multiple listing (if applicable)

Section number 8 Page 4

SUMMARY

The Spencer Presbyterian Church is an excellent example of Victorian Gothic architecture in an area in which most rural churches can be categorized by their wood frame construction and clad in weatherboard or synthetic siding. The church's stained glass windows, which are a unique work of art in the area, give the building its most defining character. Because it derives its primary significance from its architecture, the Spencer Presbyterian Church is eligible listing for on the National Register under Criterion C: Architecture, and under Criteria Consideration A: Religious Properties.

United States Department of the Interior
National Park Service

National Register of Historic Places
Continuation Sheet

Spencer Presbyterian Church
Name of Property
Roane County, WV
County and State
N/A
Name of multiple listing (if applicable)

Section number 9 Page 5

BIBLIOGRAPHY

Bishop, William H. *History of Roane County West Virginia: From the Time of Its Exploration to A.D. 1927*.
Spencer: West Virginia Historical Society, 1927.

King, Kenneth. "Presbyterian Church Founded Here 1874," *Centennial Newspapers: 1856-1956*.

McAllester, Virginia and Lee. *A Field Guide to American Houses*. New York: Alfred A. Knopf, Inc., 2002.

National Park Service. "Religious Architecture." *National Park Service*. Accessed November 30, 2015.
<http://www.nps.gov/nr/travel/charleston/architecture.htm>.

Oral interview with Julie Boggs, Spencer resident and church's current owner

Roane County Family History Committee. *Roane County, West Virginia Family History 1989*. Marceline:
Walsworth Publishing, 1990.

Spencer Presbyterian Church Minutes, 1901-1911

United States Department of the Interior
National Park Service

National Register of Historic Places
Continuation Sheet

Spencer Presbyterian Church

Name of Property

Roane County, WV

County and State

N/A

Name of multiple listing (if applicable)

Section number 10 Page 6

VERBAL BOUNDARY DESCRIPTION

Roane County, West Virginia Tax Map: Spencer District, Map 3, Parcel 197

BOUNDARY JUSTIFICATION

The National Register boundary corresponds with the legal parcel of the Spencer Presbyterian Church as stated above.

United States Department of the Interior
National Park Service

National Register of Historic Places
Continuation Sheet

Spencer Presbyterian Church
Name of Property
Roane County, WV
County and State
N/A
Name of multiple listing (if applicable)

Section number Photos Page 7

PHOTOS

Name of Property: Spencer Presbyterian Church
City or Vicinity: Spencer
County: Roane State: WV
Photographer: Andrew Lore, WV SHPO
Date Photographed: October 5 2015 and January 5, 2016
Original digital files stored at the WV SHPO.

Photo 1 of 8	Exterior of church, facing northwest
Photo 2 of 8	Exterior of church, facing northeast
Photo 3 of 8	Front façade of church with stained glass windows, facing northwest
Photo 4 of 8	Educational Center, facing southeast
Photo 5 of 8	Interior, stained glass, facing east
Photo 6 of 8	Interior, stained glass, facing west
Photo 7 of 8	Interior, facing north
Photo 8 of 8	Interior, ceiling, facing southeast

Photo 1 of 8: Spencer Presbyterian Church
Roane County, WV
Exterior of church, facing southwest



Photo 2 of 8: Spencer Presbyterian Church
Roane County, WV
Exterior of church, facing northeast



Photo 3 of 8: Spencer Presbyterian Church
Roane County, WV
Front facade of church with stained glass
windows, facing northwest



Photo 4 of 8: Spencer Presbyterian Church
Roane County, WV
Educational Center, facing southeast



Photo 5 of 8: Spencer Presbyterian Church
Roane County, WV
Interior, stained glass, facing east



Photo 6 of 8: Spencer Presbyterian Church
Roane County, WV
Interior, stained glass, facing west



**Photo 7 of 8: Spencer Presbyterian Church
Roane County, WV
Interior, facing north**





**Photo 8 of 8: Spencer Presbyterian Church
Roane County, WV
Interior, facing southeast**

Exterior Photos, Spencer Presbyterian Church, Roane County, WV



This map is created by West Virginia GIS Technical Center for West Virginia SHPO GIS Map Viewer.

Coordinate System: WGS 1984 Web Mercator (Auxiliary Sphere)

Map Created on 11/24/2015

Architectural

- Point
- Area

National Register

- Point
- Area

User Notes:

No USGS 7.5' topographic quadrangles for West Virginia at this map extent.

Disclaimer:

The West Virginia State Historic Preservation Office Interactive Map is designed to provide professional consultants, state/federal agency employees and the public with a means to make informed decisions with regards to the cultural resource location.



Interior Photo Map
Spencer Presbyterian Church
Roane County, West Virginia
Not to scale

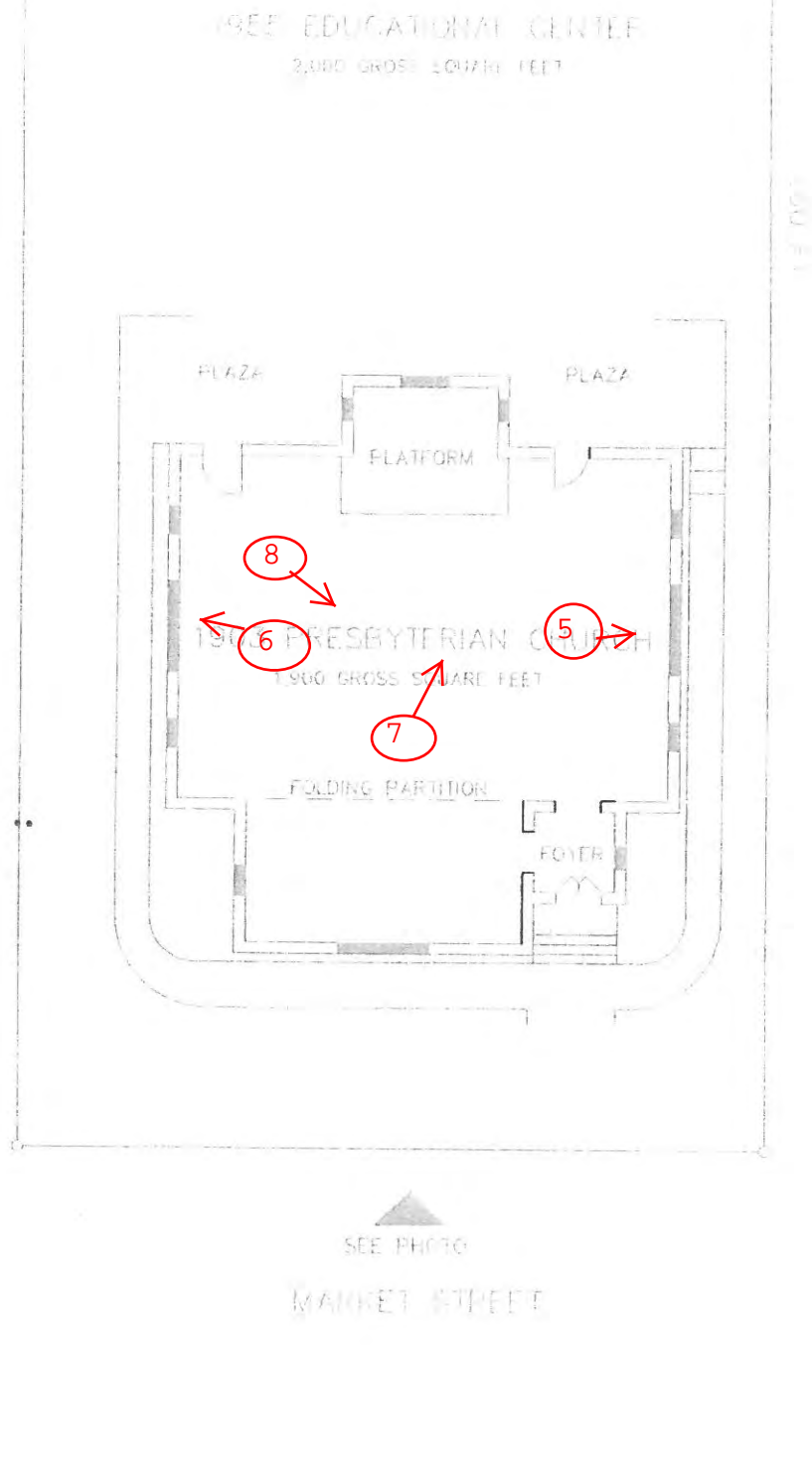

Spencer Presbyterian Church, Roane County, WV

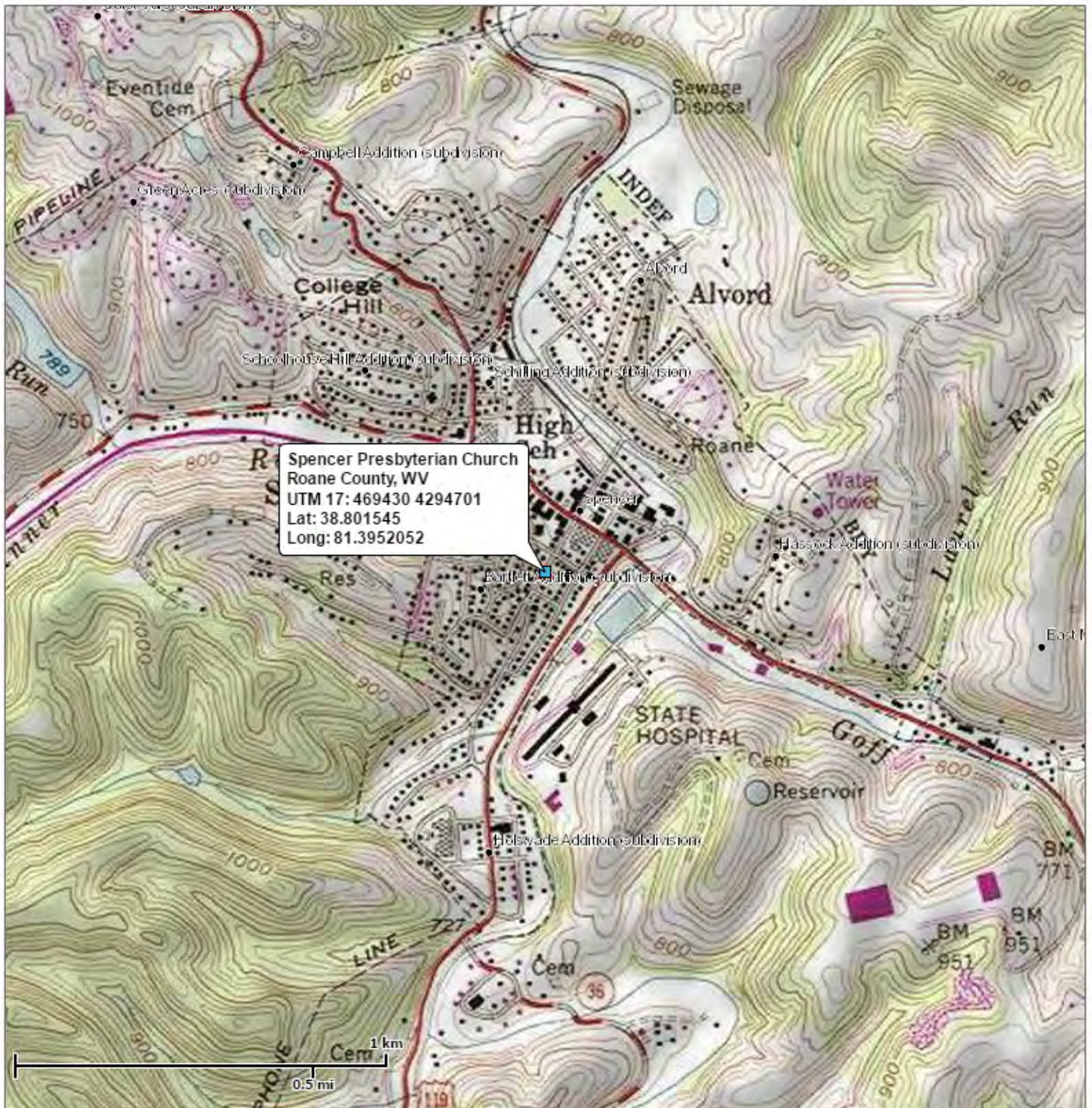

This map is created by West Virginia GIS Technical Center for West Virginia SHPO GIS Map Viewer.

Coordinate System: WGS 1984 Web Mercator (Auxiliary Sphere)

Map Created on 11/23/2015

Architectural

- Point
- ▨ Area

National Register

- Point
- ▨ Area

User Notes:

No USGS 7.5' topographic quadrangles for West Virginia at this map extent.

Disclaimer:

The West Virginia State Historic Preservation Office Interactive Map is designed to provide professional consultants, state/federal agency employees and the public with a means to make informed decisions with regards to the cultural resource location.



Spencer Presbyterian Church, Roane County, WV



This map is created by West Virginia GIS Technical Center for West Virginia SHPO GIS Map Viewer.

Coordinate System: WGS 1984 Web Mercator (Auxiliary Sphere)

Map Created on 11/5/2015

Architectural

- Point
- Area

National Register

- Point
- Area

User Notes:

No USGS 7.5' topographic quadrangles for West Virginia at this map extent.

Disclaimer:

The West Virginia State Historic Preservation Office Interactive Map is designed to provide professional consultants, state/federal agency employees and the public with a means to make informed decisions with regards to the cultural resource location.

