

FILE

NPS Form 10-900
(Rev. 8-86)

OMB No. 1024-0018

United States Department of the Interior National Park Service

NATIONAL REGISTER OF HISTORIC PLACES REGISTRATION FORM

1. Name of Property

historic name: Mulliss, George W.F., House

other name/site number: _____

2. Location

street & number: Located on the west side of U.S. Route #11, one mile south of the Martinsburg city limits.

not for publication: N/A

city/town: Martinsburg

vicinity: X

state: WV county: Berkeley code: 003 zip code: 25401

3. Classification

Ownership of Property: Private

Category of Property: Buildings

Number of Resources within Property:

Contributing	Noncontributing
<u>2</u>	<u>2</u> buildings
<u> </u>	<u> </u> sites
<u> </u>	<u>1</u> structures
<u> </u>	<u> </u> objects
<u>2</u>	<u>3</u> Total

Number of contributing resources previously listed in the National Register: N/A

Name of related multiple property listing: N/A

=====
4. State/Federal Agency Certification
=====

As the designated authority under the National Historic Preservation Act of 1986, as amended, I hereby certify that this X nomination _____ request for determination of eligibility meets the documentation standards for registering properties in the National Register of Historic Places and meets the procedural and professional requirements set forth in 36 CFR Part 60. In my opinion, the property X meets _____ does not meet the National Register Criteria. _____ See continuation sheet.

W. W. De

Signature of Certifying Official

3/11/91

Date

State or Federal agency and bureau

In my opinion, the property _____ meets _____ does not meet the National Register criteria. _____ See continuation sheet.

Signature of commenting or other official

Date

State or Federal agency and bureau

=====
5. National Park Service Certification
=====

I, hereby certify that this property is:

_____ entered in the National Register

_____ See continuation sheet.

_____ determined eligible for the National Register

_____ See continuation sheet.

_____ determined not eligible for the National Register

_____ removed from the National Register

_____ other (explain): _____

Signature of Keeper

Date of Action

=====
6. Function or Use
=====

Historic: _____ Domestic _____ Sub: _____ Single Dwelling

Current : _____ Domestic _____ Sub: _____ Single Dwelling

=====

7. Description

=====

Architectural Classification:
Neo Georgian Revival

=====

Other Description: N/A

Materials: foundation Stone roof Slate
walls Stone other _____

Describe present and historic physical appearance. X See continuation sheet.

=====

8. Statement of Significance

=====

Certifying official has considered the significance of this property in relation to other properties: Local.

Applicable National Register Criteria: B, C

Criteria Considerations (Exceptions) : N/A

Areas of Significance: Architecture
Industry

Period(s) of Significance: 1929-1940

Significant Dates : 1929 _____

Significant Person(s): George W. F. Mulliss

Cultural Affiliation: N/A

Architect/Builder: Alexander Merchant, Architect

State significance of property, and justify criteria, considerations, and areas and periods of significance noted above.
X See continuation sheet.

United States Department of the Interior
National Park Service

National Register of Historic Places
Continuation Sheet

Section number 7 Page 1

Situated on a hill at the end of a circular driveway, "Hartwood" is a large (ninety-seven feet by thirty-nine feet) two-and-a-half story, central block with wings, Neo Georgian Revival dwelling house. It is constructed with a two-inch air gap between the eight-inch outer wall of random coursed, cut rockfaced Pennsylvania blue limestone and the eight-inch inner wall of locally quarried limestone, reinforced with steel. The central section is seven bays wide with inside end chimneys, the one-story kitchen or south wing is two bays wide, and the north wing is a one-story, shed roofed sunporch. The house was designed by New Jersey architect Alexander Merchant for Mr. George Mulliss who built the house in 1929.

The one-bay, one-story pedimented main entrance porch has a panelled ceiling and features Tuscan columns with like pilasters built on a stone foundation with stone floor. The walkway is stone with cut stone slab steps and a stone lined gutter runs under the steps. The panelled entrance door is highlighted with an elliptical fanlight and sidelights with tracery, all framed by a cut-stone arch. Windows are 8/8 double hung sash including the four fully pedimented dormers located on both the front and rear roof planes of the main section. Located on the rear facade of the main section is a three-bay, two-story, shed roof porch with stone floor. The south wing has a like porch of one story. The sunporch has five sets of French doors with transoms and sidelights, set in panelled pilasters on a stone foundation with flagstone floor.

Other decorative features include a molded cornice across both the front and rear facades and the same type of cornice is used for the gable board trim. The two inside end chimneys of the central block are both flanked in the gable with half fanlight windows with cut stone trim.

Alterations to the exterior are the removal of the second floor of the two-story porch (due to burglary) and the construction of the third chimney on the south wing end gable for a fireplace.

The main section of "Hartwood" has a full depth hall (thirty-six feet by ten feet). The entrance door is flanked by a broken ceiling cornice which consists of a full entablature of a heavy cyma recta cornice molding with a plain frieze and a dental architrave. This cornice is used extensively in all the first floor rooms but the kitchen. The main staircase is an open-well, two-flight stair with panelled case and three round-in-section spokes per step, in the Georgian style. The handrail is finely molded and meets each newel in a graceful easement.

United States Department of the Interior
National Park ServiceNational Register of Historic Places
Continuation SheetSection number 7 Page 2

The large living room (thirty-six feet by eighteen feet) is entered through double panelled doors and has a large fireplace with a cyma recta and fillet molded mantel shelf with cavetto and bead bed moldings. The over mantel is panelled and the fireplace is flanked by panelled door cupboards. This design is based on a panelled fireplace wall located in an old tavern (ca. 1750) in Haddonfield, New Jersey. The Langs (present owners) have Alexander Merchant's architectural plans of "Hartwood." Flanking the chimney are French doors leading to the sunroom which also has a stone fireplace. Other rooms on the first floor include a small parlor, dining room, breakfast room, kitchen, and pantry. A "cross hall," with a keystone arch entrance off the main hall, gives access to most of these rooms. The main architectural feature of the dining room is the matching keystone arched, panelled door storage cupboards that flank the door to the pantry and kitchen. In the pantry are original storage cupboards with paned glass in the upper doors.

Located off the pantry is a small enclosed, open-well, closed-string stair of four flights that leads to the second and third floors. On the second floor are five bedrooms, three baths, and a storage room. On the third floor is a bedroom with full bath for servants' quarters, a storage room with cupboards, and a large ballroom (forty feet by thirty-six feet) with fireplace. The mantel is similar to that in the sunroom with a heavy plain mantel shelf supported by ogee brackets.

All doors throughout the house (including closet doors) are eight raised-panel doors, two inches thick. The lock mechanisms are located within the doors so that only the small brass knobs and brass escutcheons show. Window jambs are splayed and panelled and all window and door trim is shouldered architrave trim. Original random-width flooring is used throughout the house.

There have been no alterations to the interior of the house except for modernizing the kitchen with the addition of a counter area and new appliances, and the replacing of some of the bathroom sinks. There are five bathrooms in the house. The house is well taken care of and is in excellent condition.

The three-bay, story-and-a half garage was also designed by Alexander Merchant and is constructed of stone in like manner. Two fully pedimented dormers are in both the front and rear roof planes. Two frame, noncontributing additions have been made to the garage to accommodate Mr. Lang's factory, after 1955. Additionally a noncontributing swimming pool and a noncontributing shed roofed his-and-her pool house have been constructed.

United States Department of the Interior
National Park ServiceNational Register of Historic Places
Continuation SheetSection number 3 Page 1

"Hartwood" is historically significant under Criterion B for its association with George Mulliss, an industrialist. Mulliss made major contributions to the development of the area. It is architecturally significant under Criterion C for being the most outstanding example of Neo Georgian Revival architecture in Berkeley County.

George W. F. Mulliss was born in Leicester, England, and came to Lowell, Massachusetts, in 1890 where his father was associated with hosiery manufacturing. The family moved to New Brunswick, New Jersey, where William Mulliss (father) was the plant manager of the Kilbourn Mill. In 1895, they moved to Martinsburg, WV, where William Mulliss was in charge of finishing operations for the Kilbourn Knitting Machine Company. George Mulliss began his long career in 1897, in Martinsburg, with the Kilbourn Mill. This company was taken over by Interwoven Mills in 1932 and George Mulliss was made president of the local company. In 1936, it was merged with the greater Interwoven Stocking Company of New Brunswick, New Jersey, and Mulliss became vice president and director of operations of the Martinsburg mills and was the longest serving member on the board of directors in the history of Interwoven Stocking Company, at one time the largest men's stocking mill in the world. The Martinsburg mill employed 1500 people, by far the largest single employer in Berkeley County ever. The mills had a tremendous impact on Martinsburg causing a building boom, among other effects. George Mulliss is remembered as having run the mill like a "dictator." The guards saluted him as he came to work, no one was allowed to sit in his presence, and his management people sat at "Mahogany Row," a row of desks outside his office. Under Mulliss' guidance, the mill by 1940 reached its heyday. He died in 1953. (In 1980, these mill buildings, along with others, were listed on the National Register as a complex of Romanesque Revival industrial buildings. Also listed was a large residential district of mill workers' homes called "Boom Town.")

George Mulliss married two of the three daughters of Rev. Dr. Francis Marion Woods, Rebecca Woods Mulliss who died in 1912 and Mary Woods Mulliss who died in 1952. Dr. Woods lived at "Hartwood" and named it after the first church where he served a pastor, the Hartwood Presbyterian Church near Fredericksburg, Va., from 1867 to 1872. He came to Martinsburg in 1879 and served as pastor of the Presbyterian Church here until 1926, forty-seven years. Under his pastorship, the present church building was erected and dedicated in 1903. This is a large and expansive building, a very impressive and elaborate example of Colonial Revival church architecture (National Register District of 1980). The Rev. Francis Woods, D.D., pastor emeritus, died at "Hartwood" in 1939, at the age of ninety-six. He was very active in church work locally and throughout the Shenandoah Valley. He was regarded as Nestor of the Synod of Virginia, a tribute to his extensive work.

United States Department of the Interior
National Park ServiceNational Register of Historic Places
Continuation SheetSection number 3 Page 2

"Hartwood" was purchased in 1955 by Mr. and Mrs. Samuel G. Lang of Cincinnati, Ohio. Mr. Lang graduated from the University of Cincinnati in 1933 in the College of Engineering, School of Ceramics. A few months later, he became a partner in Barrows Porcelain Enamel Corporation. He then founded Fustive Corporation, with a partner, which manufactured glass and metal headers, a product that Mr. Lang had developed in his home basement workshop in Cincinnati. Today, Fustive is an international firm. Mr. Lang sold these two partnerships in order to finance the founding of Hartwood Glass & Metals Corporation, of which he is the sole owner, in Martinsburg, WV. After a year-and-a-half of intensive research, he invented a glass coated electrical component, able to withstand extremely high temperatures. The additions to the stone garage were made to house this factory. These components were used in the manufacturing of electrical switches and were sold to (among others) Hi-G, General Electric, Teledyne, Struthers Dunn, and Tektronix. Through Hi-G, Inc., these parts were used in the Apollo Lunar Space Program and some were left on the moon. Today, no other company has yet to develop the equivalent of this ceramic formula.

Mr. George Mulliss, in particular, was an exceptional person and made outstanding contributions to the development of the area through his industrial enterprise.

"Hartwood" is significant as an excellent example of Neo Georgian Revival architecture. The house is regarded in the area as a one-of-a-kind architectural achievement. This reputation is one that has been handed down to present day having its beginnings in the era of construction but it is also one that the house still justifies. People were fascinated with the construction of "Hartwood" at the time and people still are. There are other domestic Georgina Revival buildings in Martinsburg, but nearly all are built of either frame or brick and none approach "Hartwood" in size, extensiveness of design, or craftsmanship. The handsome entrance hall with panelled staircase, the panelled window reveals, trim, doors, cornices, and mantels are all architectural elements that are used throughout the house creating a flow of design work that represents an accurate interpretation of a Georgian manor house.

The rooms are spacious and the space free flowing. Each room is a complement to the other rooms and there is a feeling of elegance and warmth. Built of stone and steel, the house shows no signs of wear after six decades. There are no cracked plaster walls and all the mortar is the original and does not need repair.

George Mulliss commissioned "Hartwood" in 1929. Today, "Hartwood" is an excellent example of Neo Georgian Revival architecture and is the most outstanding example of its style and era in Berkeley County.

=====

9. Major Bibliographical References

=====

X continuation sheet.

Previous documentation on file (NPS): N/A

- preliminary determination of individual listing (36 CFR 67) has been requested.
- previously listed in the National Register
- previously determined eligible by the National Register
- designated a National Historic Landmark
- recorded by Historic American Buildings Survey # _____
- recorded by Historic American Engineering Record # _____

Primary Location of Additional Data:

- State historic preservation office
- Other state agency
- Federal agency
- Local government
- University
- Other -- Specify Repository: Owner: Architectural drawings
Berkeley County Historic Landmark
Commission, M-171, County Survey

=====

10. Geographical Data

=====

Acreage of Property: 6 acres

UTM References: Zone Easting Northing Zone Easting Northing

A	<u>18</u>	<u>242830</u>	<u>4368610</u>	B	_____	_____
C	_____	_____	_____	D	_____	_____

Verbal Boundary Description: See continuation sheet.

Beginning on the W right of way line of US Route #11, 80 ft N of the driveway, thence along said R/W line S 280 ft, thence SW 420 ft, thence W 320 ft to a point 140 ft SW of the factory, thence N 400 ft, thence E 550 ft to the beginning (See sketch map).

Boundary Justification: See continuation sheet.

The dwelling and its secondary resources occupy the tract historically associated with the property.

=====

11. Form Prepared By

=====

Name/Title: Frances D. Ruth

Organization: Berkeley County Historic
Landmarks Commission

Date: September 6, 1985
Updated 11/1990

Street & Number: c/o WV SHPO

Telephone: 304-348-0240

City or Town: Charleston

State: WV ZIP: 25305

United States Department of the Interior
National Park Service

National Register of Historic Places Continuation Sheet

Section number 9 Page 2

Bibliographical References

Berkeley County Deed Book, Will Books, Land Books.

Martinsburg Statesman, issues 2/11/1886, 2/25/1896, and 5/1/1903.

Martinsburg Journal, issues 9/7/1926, 6/7/1939, 10/22/1953,
and 12/11/1953.

The Statesman and The Journal are on microfilm, Public Library,
Martinsburg, W.V.

Interview, Frances Ruth with Samuel Lang at "Hartwood," 6/3/1985 and
7/16/1985.

GEORGE W. F. MULLISS HOUSE

M-171

Martinsburg Quadrangle

Berkeley County, West Virginia

Area 6 acres

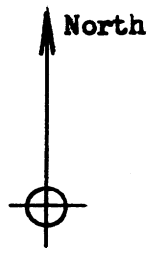
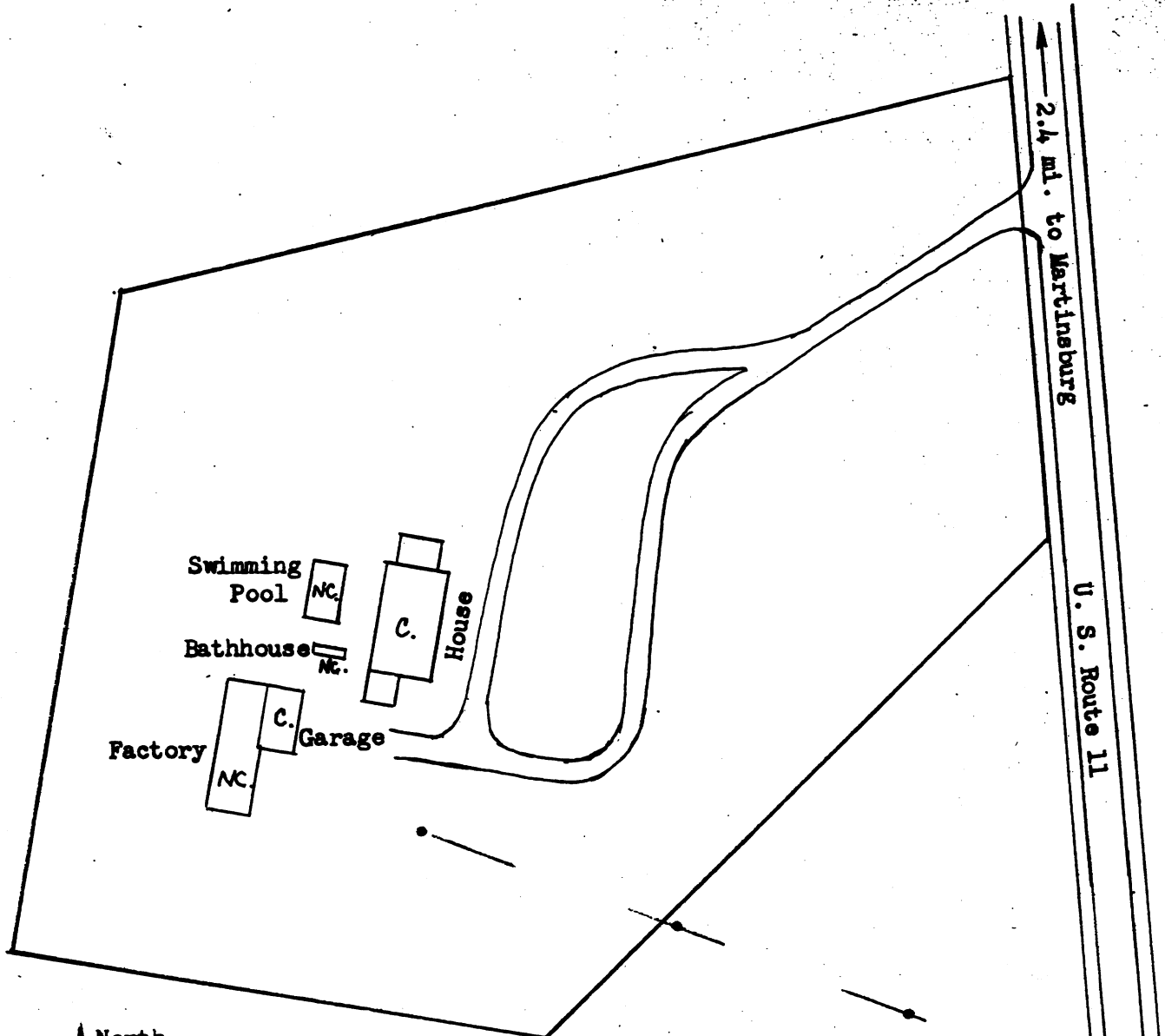

SCALE
1 inch = 100 feet
0 100

Drawn August 1985
by Galtjo L. Geertsema

C = CONTRIBUTING
NC = NONCONTRIBUTING

GEORGE W. F. MALLISS HOUSE
1 Mile South of
MARTINSBURG, WV
BERKELEY COUNTY
18-242530-4365610



