

**SUPPLEMENTARY LISTING RECORD**

NRIS Reference Number: 91000557 Date Listed: 5/17/91

Elizabeth Kunkel House Berkeley WV  
Property Name: County: State:

\_\_\_\_\_  
Multiple Name

-----  
This property is listed in the National Register of Historic Places in accordance with the attached nomination documentation subject to the following exceptions, exclusions, or amendments, notwithstanding the National Park Service certification included in the nomination documentation.

*for* Patrick Andrews  
Signature of the Keeper

5/22/91  
Date of Action

=====  
Amended Items in Nomination:

The Period of Significance for this property had to be clarified. The building is nominated for Architectural significance under Criterion C, so the Period of Significance is confined to the year of its construction - 1907. This has been confirmed with Michael Pauley of the WV SHPO.

\_\_\_\_\_  
**DISTRIBUTION:**  
National Register property file  
Nominating Authority (without nomination attachment)

United States Department of the Interior National Park Service  
NATIONAL REGISTER OF HISTORIC PLACES REGISTRATION FORM

1. Name of Property

historic name: Kunkel, Elizabeth, House

other name/site number: \_\_\_\_\_

2. Location

street & number: Located on the west side of U.S. Route #11, 2.4 miles north of Martinsburg, West Virginia.

not for publication: \_\_\_\_\_

city/town: Martinsburg

vicinity: X

state: WV county: Berkeley code: 003 zip code: 25401

3. Classification

Ownership of Property: Private

Category of Property: Buildings

Number of Resources within Property:

Contributing	Noncontributing
<u>3</u>	<u>1</u> buildings
_____	_____ sites
_____	_____ structures
_____	_____ objects
<u>3</u>	<u>1</u> Total

Number of contributing resources previously listed in the National Register: N/A

Name of related multiple property listing: N/A

=====  
4. State/Federal Agency Certification  
=====

As the designated authority under the National Historic Preservation Act of 1986, as amended, I hereby certify that this X nomination \_\_\_\_\_ request for determination of eligibility meets the documentation standards for registering properties in the National Register of Historic Places and meets the procedural and professional requirements set forth in 36 CFR Part 60. In my opinion, the property X meets \_\_\_\_\_ does not meet the National Register Criteria. \_\_\_\_\_ See continuation sheet.

W. W. [Signature]  
Signature of Certifying Official

3/11/91  
Date

\_\_\_\_\_  
State or Federal agency and bureau

In my opinion, the property \_\_\_\_\_ meets \_\_\_\_\_ does not meet the National Register criteria. \_\_\_\_\_ See continuation sheet.

\_\_\_\_\_  
Signature of commenting or other official

\_\_\_\_\_  
Date

\_\_\_\_\_  
State or Federal agency and bureau

=====  
5. National Park Service Certification  
=====

I, hereby certify that this property is:

\_\_\_\_\_ entered in the National Register  
\_\_\_\_\_ See continuation sheet.

\_\_\_\_\_ determined eligible for the  
National Register

\_\_\_\_\_ See continuation sheet.

\_\_\_\_\_ determined not eligible for the  
National Register

\_\_\_\_\_ removed from the National Register

\_\_\_\_\_ other (explain): \_\_\_\_\_

\_\_\_\_\_  
Signature of Keeper

\_\_\_\_\_  
Date of  
Action

=====  
6. Function or Use  
=====

Historic:

Domestic

Sub:

Single Dwelling

Current :

Domestic

Sub:

Single Dwelling

7. Description

Architectural Classification:  
Late Victorian Gothic

Other Description: N/A

Materials: foundation Stone Rubble roof Slate  
walls Wood other \_\_\_\_\_

Describe present and historic physical appearance. X See continuation sheet.

8. Statement of Significance

Certifying official has considered the significance of this property in relation to other properties: Local.

Applicable National Register Criteria: C

Criteria Considerations (Exceptions) : N/A

Areas of Significance: Architecture  
\_\_\_\_\_  
\_\_\_\_\_  
\_\_\_\_\_  
\_\_\_\_\_

Period(s) of Significance: 1907-1940

Significant Dates : 1907 \_\_\_\_\_

Significant Person(s): N/A  
\_\_\_\_\_

Cultural Affiliation: N/A

Architect/Builder: Not Known  
\_\_\_\_\_  
\_\_\_\_\_

State significance of property, and justify criteria, considerations, and areas and periods of significance noted above. X See continuation sheet.

United States Department of the Interior  
National Park Service

## National Register of Historic Places Continuation Sheet

Section number 7 Page 1

The Elizabeth Kunkel House was built in 1907 and is located on U.S. Route #11, 2.4 miles north of Martinsburg, West Virginia. It is situated on the west side of the road above a gently sloping lawn. The house is at the top of the rise with all outbuildings in the rear yard. All buildings are in excellent condition.

The two-story, gable roofed house is an "L" shape of Late Victorian Gothic design and measures forty feet across the front by fifty feet deep. It is built of novelty siding on a stone foundation. The one-story, three-bay entrance porch has a hip roof over Tuscan columns with no balustrade. The double doors of the main entrance both have a single vertical glass panel and are highlighted by a full width transom. The exterior door and window trim is reeded and all fenestration has the open triangular pediment of the period, a very nice effect. Two projecting, gabled bay windows flank the entrance porch. Both gablets have a full cornice pediment with returns. The tympanum is shingled in an imbricated pattern with small 1/1 double-hung sash windows with peaked pediment, rather fanciful. The shingle pattern is repeated on a course between the first and second story of the bay windows. All windows are 1/1 double hung sash and all have shutters except those on the front facade.

On the north side is a two-tiered recessed porch with pantries. The balustrade is intact behind the screening. Over the basement doors is a small, hip-roofed frame foyer type entrance, an addition for moisture protection.

The plan of the house features a central hall with one room on each side. These are large, spacious, sunlit rooms, twenty-five feet by twenty feet. The ell is two rooms deep. In the hall, the main entrance is flanked by panelled, double pocket doors that lead to the living room and parlor. The trim in the hall is finely decorative and is symmetrically molded with tall rounded corner blocks. The hall is "L" shaped and the main stair is located in the back ell, behind the parlor, and consists of a two-flight, open-well stair with turned balustrade and a single newel of heavy Gothic design. The newel has two vertical panels and a carved sunburst on each side, and a heavy cap.

There are only two fireplaces in the house, one in the living room and one in the kitchen. The mantel in the living room is a very heavy Gothic piece with the bed moldings projecting over the cartouche, decorative applied panels on the frieze, end blocks, and heavy shaped pilasters. Also in this room is a handsome two-tiered, double, panelled door built-in corner cupboard. Between this room and the kitchen is a large pantry with built-in cupboards.

United States Department of the Interior  
National Park Service

## National Register of Historic Places Continuation Sheet

Section number 7 Page 2

---

On the second floor, there are two large bedrooms with bay windows in the front; an arched entry leads from the main hall to the ell where there are closets and a single bedroom. This room has plainer trim and a winder staircase with a board-and-batten door that leads to the attic.

Three subsidiary buildings stand behind the house. These include an early 20th century frame smokehouse (contributing), an early 20th century frame storage building (contributing), and a noncontributing 2-bay frame garage that is less than fifty years of age.

United States Department of the Interior  
National Park Service

## National Register of Historic Places Continuation Sheet

Section number 8 Page 1

The Elizabeth Kunkel House meets Criterion C of the National Register because it is a rare and significant example of Late Victorian Gothic rural domestic architecture in Berkeley County.

The Kunkel farm was part of a tract of land that had belonged to Henry St. George Tucker. In 1864, 145 acres was sold to W.W. Rutherford of Pennsylvania. Elizabeth Kunkel was his daughter and she inherited the farm in 1886. She resided in Harrisburg, Pennsylvania, and, at her death in 1917, the Kunkel farm passed to her grandson John Kunkel. She also bequeathed \$1,000.00 to the Dauphine County Historical Society of Pennsylvania, among other generous bequests. John Kunkel sold lots from part of the farm after World War I as a residential development that is known as Kunkel's Addition. Kunkel was among the first to develop land on the north side of Martinsburg. Today "Berkeley Plaza," the major shopping center in the county, is located on part of this farm. Kunkel was instrumental in beginning the development of this area of the county.

The Elizabeth Kunkel House is an excellent example of Late Victorian Gothic (1907) rural domestic architecture. Berkeley County has some examples of fine Victorian era domestic architecture in the city of Martinsburg but examples are very rare in the rural areas. Most farms in area have pre-Civil War period houses and only occasionally, rarely in fact, is there a Victorian period farmhouse. Because of the far greater numbers of examples of pre-Civil War architecture, Victorian architecture is not much appreciated. It is deemed to be not old enough and therefore alterations, particularly removal of the front porch and panelling the rooms, is almost always done. Removing the front porch is intended to make the house appear more classical, more like area pre-Civil War houses. The Kunkel House has not been altered significantly and it is an excellent representative of its period and style. It is also located in a busy and visible area and the house and outbuildings have a certain amount of visual impact on passers-by on U.S. Route #11. It is hoped that, by recognition of Victorian era rural architecture, a new appreciation of this period and style will help preserve and perhaps encourage restoration of these few, but deserving, period dwelling houses.

The Kunkel House is a tall, skillfully carpentered residence featuring two steeply pitched Gothic dormers containing tall Gothic windows. These dormers surmount three-sided, two-story bays that are faced in combinations of novelty siding and imbricated wood shingles. These features, in addition to the superb woodwork of the interior, provide an unusually well-preserved example of Berkeley County's early 20th century architecture.

9. Major Bibliographical References

X See continuation sheet.

Previous documentation on file (NPS): N/A

- preliminary determination of individual listing (36 CFR 67) has been requested.
- previously listed in the National Register
- previously determined eligible by the National Register
- designated a National Historic Landmark
- recorded by Historic American Buildings Survey # \_\_\_\_\_
- recorded by Historic American Engineering Record # \_\_\_\_\_

Primary Location of Additional Data:

- State historic preservation office
- Other state agency
- Federal agency
- Local government
- University

X Other -- Specify Repository: Berkeley County Historic Landmark Commission, M-170, County Survey

10. Geographical Data

Acreage of Property: 1.2 acres

UTM References: Zone Easting Northing      Zone Easting Northing

A	<u>18</u>	<u>246550</u>	<u>4374780</u>	B	_____	_____
C	_____	_____	_____	D	_____	_____

Verbal Boundary Description: See continuation sheet.

The nominated property comprises the entire 1.244 acre lot, fronting 154 ft on the west side of U.S. Route #11 and running back at right angles 352 ft. (See sketch map)

Boundary Justification: See continuation sheet.

The house and ancillary resources occupy the lot historically associated with the property.

11. Form Prepared By

Name/Title: Frances D. Ruth

Organization: Berkeley County Historic Landmark Commission

Date: September 6, 1985; updated 11/90.

Street & Number: c/o WV SHPO

Telephone: 304-348-0240

City or Town: Charleston

State: WV ZIP: 25401



ELIZABETH KUNKEL HOUSE

M-170

Martinsburg Quadrangle

Berkeley County, West Virginia

Area 1 acre

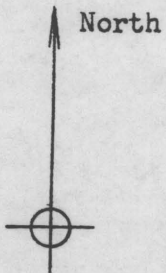
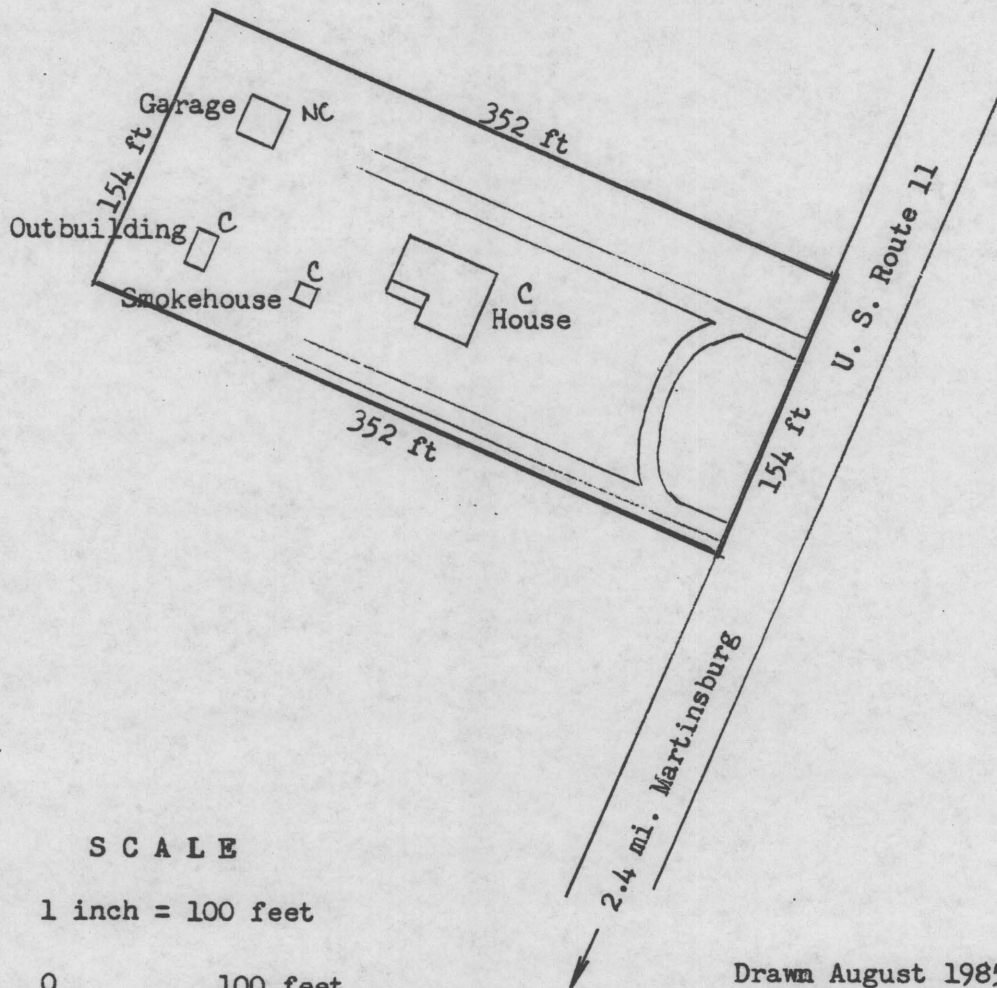

SCALE

1 inch = 100 feet

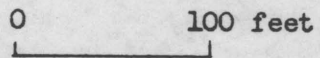

Drawn August 1985  
by Galtjo L. Geertsema

533 (1 SE)  
(BIG POOL)

UNITED STATES  
DEPARTMENT OF THE INTERIOR  
GEOLOGICAL SURVEY



STATE OF WEST VIRGINIA  
STATE OF WEST VIRGINIA  
AND OTHER STATES

78°00' 2430000E 244 BERKELEY SPRS. 18 MI. 57°30' 246 HAGERSTOWN, MD. 16 MI. 5463.  
39°30' 4376000M HEDGESVILLE 2.8 MI. (HEDGE

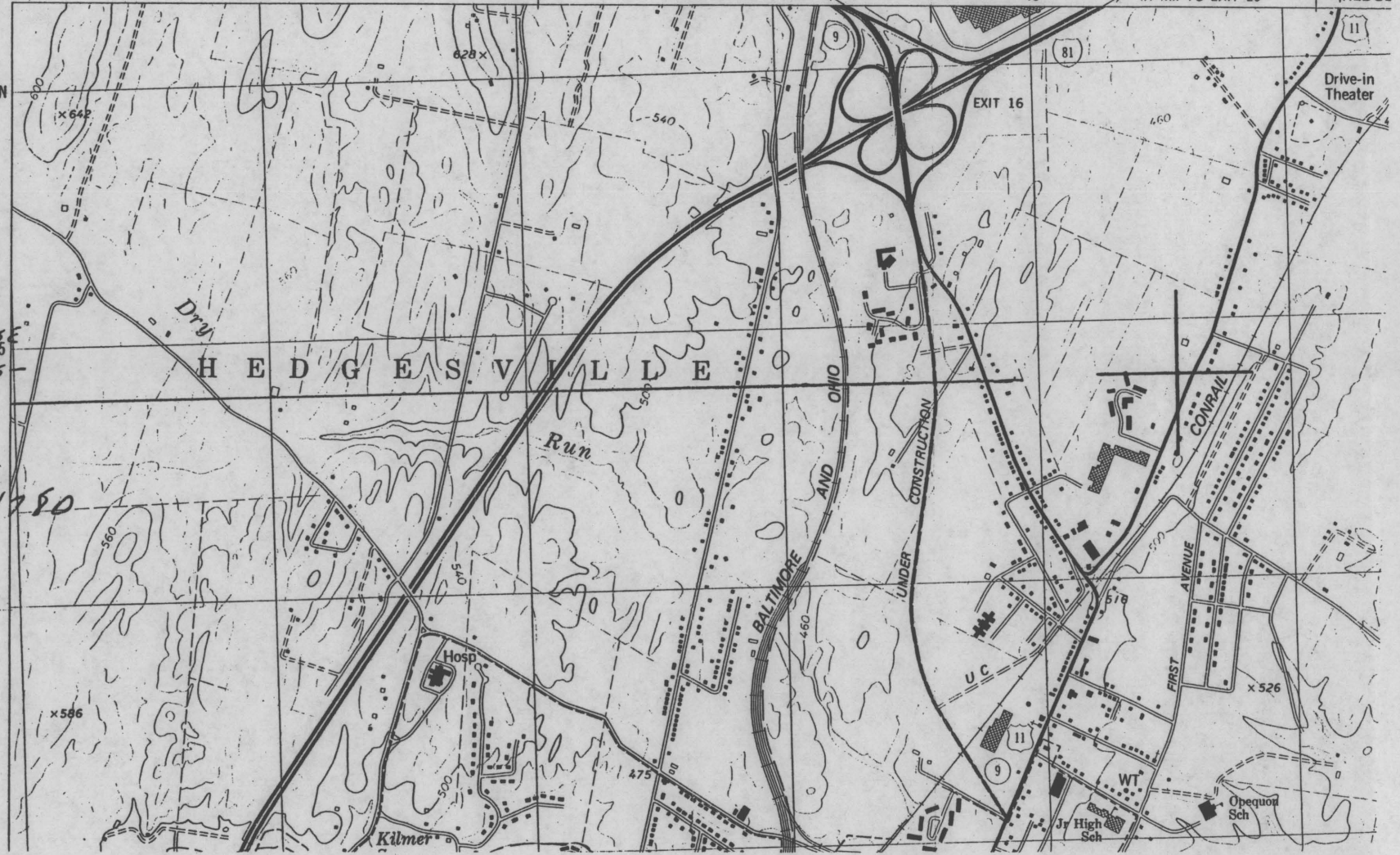

Abeth HUNKEL HOUSE  
1/4 N. of MARTINSBURG, WV.  
Berkeley County  
246550-4374780