

HISTORIC PROPERTIES INVENTORY FORM

(Staff Use Only)

HISTORIC PRESERVATION UNIT  
 DEPARTMENT OF CULTURE & HISTORY  
 SCIENCE & CULTURE CENTER  
 CHARLESTON, WEST VIRGINIA 25305

FILE NO:  
 Theme (s):  
 Reg No(s):  
 USGS Quad:  
 UTM Ref:

HUNTINGTON BUILDING EXHIBIT

1. NAME(S), historic/common: Cunningham House and outbuildings/Cunningham Farm

2. LOCATION, street/road: Burnsville Lake

city/town: Napier vicinity  
 (unincorporated)

3. USE/FUNCTION, present: Historic park

(public/)

original: Subsistence farm

4. OWNER/ADDRESS, present: U. S. Army Corps of Engineers  
 Huntington District  
 502 8th Street, Huntington, WV 25701

(public/)

original: Cunningham Heirs  
 Bulltown, W. Va.

5. PHOTO/SKETCH OF: Cunningham Farmstead

7. PLAN (include approx. dimensions):

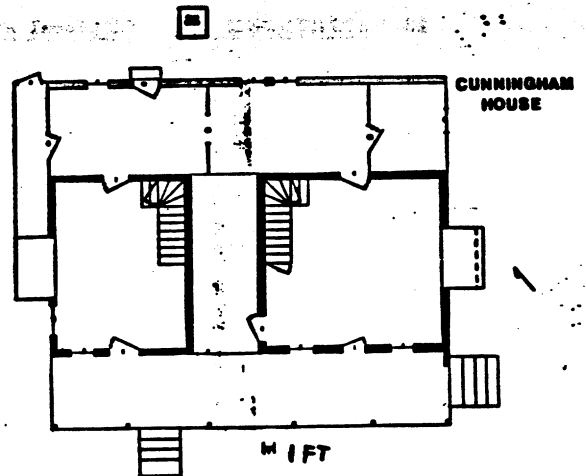
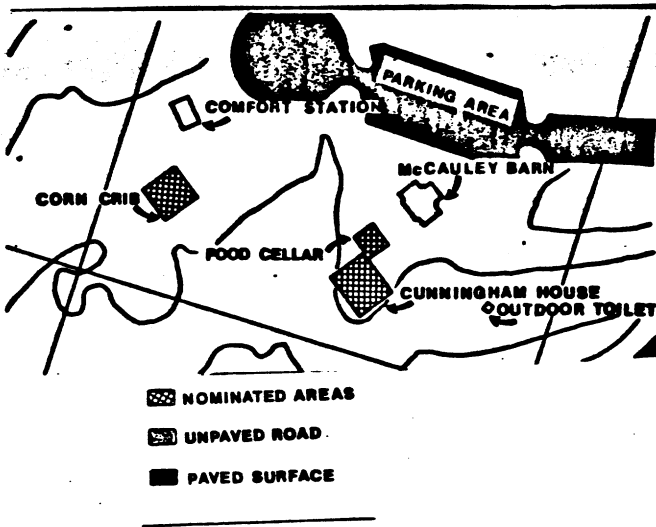

6. LOCALE/ENVIRONMENT (map):

8. ACREAGE (approx):

0.74 acre

COUNTY: BRAXTON  
 Survey Region: \_\_\_\_\_  
 Planning District: \_\_\_\_\_

9. DESCRIPTION (clarify as appropriate):

a. Exterior Fabric

stone \_\_\_\_\_  
 brick \_\_\_\_\_  
 concrete \_\_\_\_\_  
 stucco \_\_\_\_\_  
 weatherboard \_\_\_\_\_  
 clapboard X \_\_\_\_\_  
 board & batten \_\_\_\_\_  
 shingle \_\_\_\_\_  
 other \_\_\_\_\_  
 \_\_\_\_\_

b. Structural System

masonry \_\_\_\_\_  
 frame \_\_\_\_\_  
 log X \_\_\_\_\_  
 metal \_\_\_\_\_  
 other \_\_\_\_\_  
 \_\_\_\_\_  
 foundation \_\_\_\_\_  
 \_\_\_\_\_  
 \_\_\_\_\_

c. Roofing Material

wood \_\_\_\_\_  
 metal X \_\_\_\_\_  
 slate \_\_\_\_\_  
 tile \_\_\_\_\_  
 asphalt \_\_\_\_\_  
 composition \_\_\_\_\_  
 other \_\_\_\_\_  
 \_\_\_\_\_  
 \_\_\_\_\_

d. Associated Structures (use/type):

outbuildings corn crib, food  
cellar and outdoor toilet  
 \_\_\_\_\_  
 dependencies \_\_\_\_\_  
 \_\_\_\_\_  
 other \_\_\_\_\_  
 \_\_\_\_\_  
 \_\_\_\_\_

e. Integrity (include dates): 1830's - 1930's

original site/relocated original  
site  
 alterations \_\_\_\_\_  
 \_\_\_\_\_  
 additions \_\_\_\_\_  
 \_\_\_\_\_  
 \_\_\_\_\_

f. Condition:

excellent \_\_\_\_\_  
 good X \_\_\_\_\_  
 fair \_\_\_\_\_  
 deteriorated \_\_\_\_\_  
 abandoned \_\_\_\_\_

g. Threats: None

10. SIGNIFICANCE (use additional sheet if necessary):

a. Architect/Builder/Engineer:  
unknown

b. Style/Period: log house/

pre-Civil War

c. Date(s): 1930's

In terms of agriculture and architecture, the Cunningham House, granary and food cellar reflect traditional central West Virginia subsistence farming techniques which have existed relatively unchanged for over one hundred years. The house is a well-preserved log structure sided with white clapboard, one of the oldest and best preserved log structures in Braxton County.

The granary and food cellar are architecturally significant because they date to the mid 1800's and show excellent craftsmanship and quality design elements which are not present in more recent structures

11. BIBLIOGRAPHY:

Broyles, B. J., R. Liddel, and D. Berry. Archaeological Survey and Text Excavation in the Burnsville Reservoir, Braxton County. Report Submitted to National Park Service, 1975.

Michael, R. L. and R. C. Carlisle. Historical and Architectural Study of Buildings and Artifacts Associated with the Bulltown Historic Area, Burnsville Lake Project, Braxton County, West Virginia. Prepared for the U. S. Army Corps of Engineers, Huntington District, 1979.

Parkinson, G. and J. Hymes. Oral History Report of the Bulltown Historic Area. Prepared for the U. S. Army Corps of Engineers, Huntington District, 1980.

12. FORM PREPARED BY Dr. Robert F. Maslowski, DATE 28 October 1983

a. Address 502 8th Street, Huntington, WV 25701

b. Organization U. S. Army Corps of Engineers, Huntington District

