

UNITED STATES DEPARTMENT OF THE INTERIOR
NATIONAL PARK SERVICE

FOR NPS USE ONLY

RECEIVED

DATE ENTERED

14

**NATIONAL REGISTER OF HISTORIC PLACES
INVENTORY -- NOMINATION FORM**

SEE INSTRUCTIONS IN *HOW TO COMPLETE NATIONAL REGISTER FORMS*
TYPE ALL ENTRIES -- COMPLETE APPLICABLE SECTIONS

1 NAME

HISTORIC Continental Clay Brick Plant

AND/OR COMMON

2 LOCATION

STREET & NUMBER

S.E. of Martinsburg on Route 9

NOT FOR PUBLICATION

CITY, TOWN

Martinsburg

CONGRESSIONAL DISTRICT

STATE West Virginia

VICINITY OF

CODE 54

COUNTY Berkeley

CODE 003

3 CLASSIFICATION

CATEGORY

- DISTRICT
- BUILDING(S)
- STRUCTURE
- SITE
- OBJECT

OWNERSHIP

- PUBLIC
- PRIVATE
- BOTH
- PUBLIC ACQUISITION**
- IN PROCESS
- BEING CONSIDERED

STATUS

- OCCUPIED
- UNOCCUPIED
- WORK IN PROGRESS
- ACCESSIBLE**
- YES: RESTRICTED
- YES: UNRESTRICTED
- NO

PRESENT USE

- AGRICULTURE
- COMMERICAL
- EDUCATIONAL
- ENTERTAINMENT
- GOVERNMENT
- INDUSTRIAL
- MILITARY
- MUSEUM
- PARK
- PRIVATE RESIDENCE
- RELIGIOUS
- SCIENTIFIC
- TRANSPORTATION
- OTHER:

4 OWNER OF PROPERTY

NAME Continental Clay Products Company
c/o Carl Hengen

STREET & NUMBER

7394 Reservoir Road

CITY, TOWN

Springfield, Va. 22150

STATE

VICINITY OF

5 LOCATION OF LEGAL DESCRIPTION

COURTHOUSE, Berkeley County
REGISTRY OF DEEDS, ETC.

STREET & NUMBER

CITY, TOWN

Martinsburg, WV 25401

STATE

6 REPRESENTATION IN EXISTING SURVEYS

TITLE M-113, Group D, Section III, Berkeley County Historical Society & Berkeley
County Historical Landmarks Commission Survey

DATE

1973-78

FEDERAL STATE COUNTY LOCAL

DEPOSITORY FOR
SURVEY RECORDS

Berkeley County Courthouse

CITY, TOWN

Martinsburg, WV 25401

STATE

7 DESCRIPTION

CONDITION

EXCELLENT DETERIORATED
 GOOD RUINS
 FAIR UNEXPOSED

CHECK ONE

UNALTERED
 ALTERED

CHECK ONE

ORIGINAL SITE
 MOVED DATE _____

DESCRIBE THE PRESENT AND ORIGINAL (IF KNOWN) PHYSICAL APPEARANCE

An impressive battery of obsolete beehive brick kilns remain. The Company was established in 1917 at which time the first kilns were built. Originally the kilns were coal fired but later converted to gas. The discontinuance of the beehive method was replaced by a continuous production line method which is currently used. Selected kilns are still used for drying sand.

PE
PF
-14
-15
-16
-17
-18
X-19
—
SP
—
ST.

SIGNIFICANCE

PERIOD

- HISTORIC
- 1400-1499
- 1500-1599
- 1600-1699
- 1700-1799
- 1800-1899
- 1900-

AREAS OF SIGNIFICANCE -- CHECK AND JUSTIFY BELOW

- | | | | |
|-------------------------------------------------|-------------------------------------------------|-------------------------------------------------|----------------------------------------------|
| <input type="checkbox"/> ARCHEOLOGY-PREHISTORIC | <input type="checkbox"/> COMMUNITY PLANNING | <input type="checkbox"/> LANDSCAPE ARCHITECTURE | <input type="checkbox"/> RELIGION |
| <input type="checkbox"/> ARCHEOLOGY-HISTORIC | <input type="checkbox"/> CONSERVATION | <input type="checkbox"/> LAW | <input type="checkbox"/> SCIENCE |
| <input type="checkbox"/> AGRICULTURE | <input type="checkbox"/> ECONOMICS | <input type="checkbox"/> LITERATURE | <input type="checkbox"/> SCULPTURE |
| <input type="checkbox"/> ARCHITECTURE | <input type="checkbox"/> EDUCATION | <input type="checkbox"/> MILITARY | <input type="checkbox"/> SOCIAL/HUMANITARIAN |
| <input type="checkbox"/> ART | <input type="checkbox"/> ENGINEERING | <input type="checkbox"/> MUSIC | <input type="checkbox"/> THEATER |
| <input type="checkbox"/> COMMERCE | <input type="checkbox"/> EXPLORATION/SETTLEMENT | <input type="checkbox"/> PHILOSOPHY | <input type="checkbox"/> TRANSPORTATION |
| <input type="checkbox"/> COMMUNICATIONS | <input checked="" type="checkbox"/> INDUSTRY | <input type="checkbox"/> POLITICS/GOVERNMENT | <input type="checkbox"/> OTHER (SPECIFY) |
| | <input type="checkbox"/> INVENTION | | |

SPECIFIC DATES

BUILDER/ARCHITECT

STATEMENT OF SIGNIFICANCE

The Continental Clay Products beehive kilns are significant for the representation of the 19th century brick industry. Although constructed at a relatively late date, beehive kilns represent the method of producing brick used throughout the 19th century. The massing of numerous beehive ovens and chimneys makes an impressive industrial site with considerable character.

9 MAJOR BIBLIOGRAPHICAL REFERENCES

Report, Professor Emory Kemp

10 GEOGRAPHICAL DATA

ACREAGE OF NOMINATED PROPERTY 4 A.

QUADRANGLE NAME Martinsburg

QUADRANGLE SCALE _____

UTM REFERENCES

A	1, 8	2, 4, 5	3, 5, 3	4, 3, 6, 8	7, 4, 8
	ZONE	EASTING	NORTHING		

B					
	ZONE	EASTING	NORTHING		

C					
---	--	--	--	--	--

D					
---	--	--	--	--	--

E					
---	--	--	--	--	--

F					
---	--	--	--	--	--

G					
---	--	--	--	--	--

H					
---	--	--	--	--	--

VERBAL BOUNDARY DESCRIPTION

100 ft. on each side of the kilns.

LIST ALL STATES AND COUNTIES FOR PROPERTIES OVERLAPPING STATE OR COUNTY BOUNDARIES

STATE	CODE	COUNTY	CODE
-------	------	--------	------

STATE	CODE	COUNTY	CODE
-------	------	--------	------

11 FORM PREPARED BY

NAME / TITLE Don C. Wood, Genealogist, Historian, Historic Archeologist

ORGANIZATION President, Berkeley County Historical Society DATE _____
Chairman, Berkeley County Historical Landmarks Commission

STREET & NUMBER Route 3, Box 79 TELEPHONE _____

CITY OR TOWN Martinsburg, WV 25401 STATE _____

12 STATE HISTORIC PRESERVATION OFFICER CERTIFICATION

THE EVALUATED SIGNIFICANCE OF THIS PROPERTY WITHIN THE STATE IS:

NATIONAL STATE LOCAL

As the designated State Historic Preservation Officer for the National Historic Preservation Act of 1966 (Public Law 89-665), I hereby nominate this property for inclusion in the National Register and certify that it has been evaluated according to the criteria and procedures set forth by the National Park Service.

STATE HISTORIC PRESERVATION OFFICER SIGNATURE _____

TITLE _____ DATE _____

FOR NPS USE ONLY

I HEREBY CERTIFY THAT THIS PROPERTY IS INCLUDED IN THE NATIONAL REGISTER

DATE _____

KEEPER OF THE NATIONAL REGISTER

DATE _____

CHIEF OF REGISTRATION

IR-8-300A
1/78)

UNITED STATES DEPARTMENT OF THE INTERIOR
HERITAGE CONSERVATION AND RECREATION SERVICE

FOR HCRS USE ONLY
RECEIVED
DATE ENTERED

**NATIONAL REGISTER OF HISTORIC PLACES
INVENTORY--NOMINATION FORM**

M-158 *BRICK KILNS* **VERBAL BOUNDARY DESCRIPTION**

CONTINUATION SHEET

ITEM NUMBER 10 PAGE

Acreege: 5

Beginning at the main entrance at the Charles Town Road, thence up the entrance road SW 270 ft., thence NW, excluding the large new building, 660 ft., thence N along the railroad spur 330 ft., thence SE along the former railroad spur 850 ft. to the beginning.

TopoZone.com

Target is UTM 18 245353E 4368748N - **MARTINSBURG** quad [[Quad Info](#)]

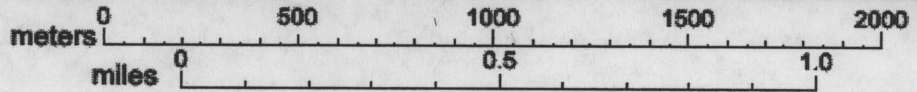

PUBLIC ROADS DIV.	STATE DIST. NO.	STATE PROJECT NO.	FED. PROJECT NO.
W.VA	5	U 202 - 9 - 15.20.01	HD 92151



WEST VIRGINIA DEPA	
PLAN SHEET	

BRICK-KILNS - CONTINENTAL CLAY PRODUCTS COMPANY
MARTINSBURG, BERKELEY CO., W. VA.

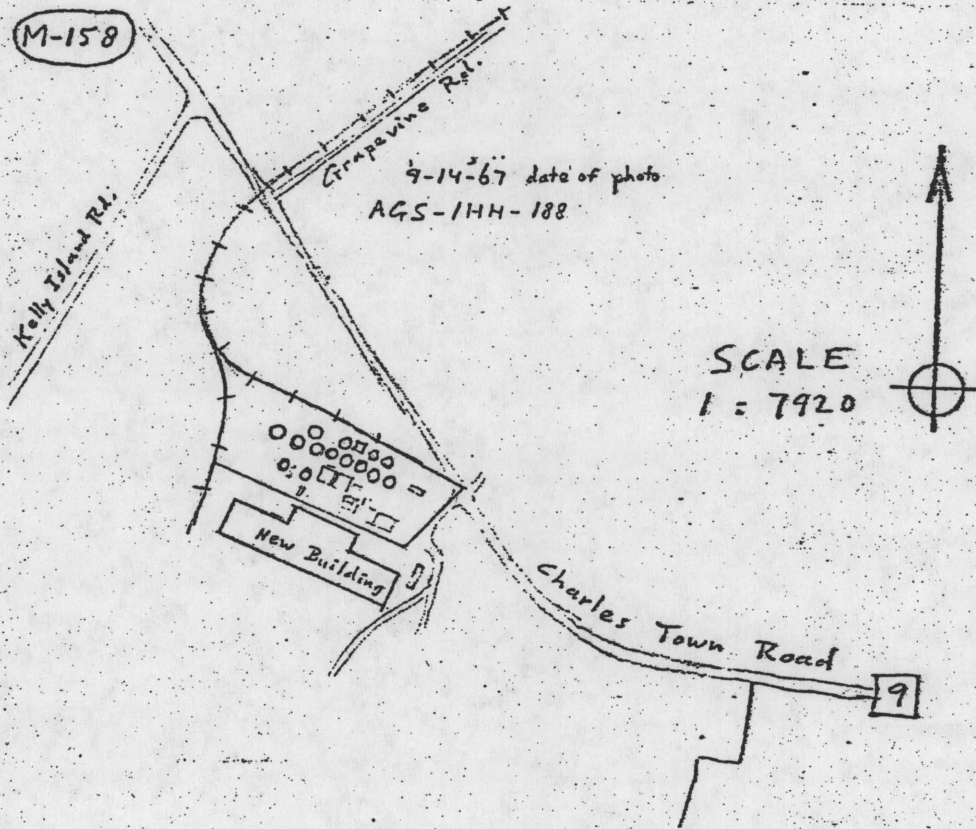

CONTINENTAL CLAY PRODUCTS
Martinsburg, Berkeley Co.

Site plan

(AS OF MAY 1998)
K. Jordan

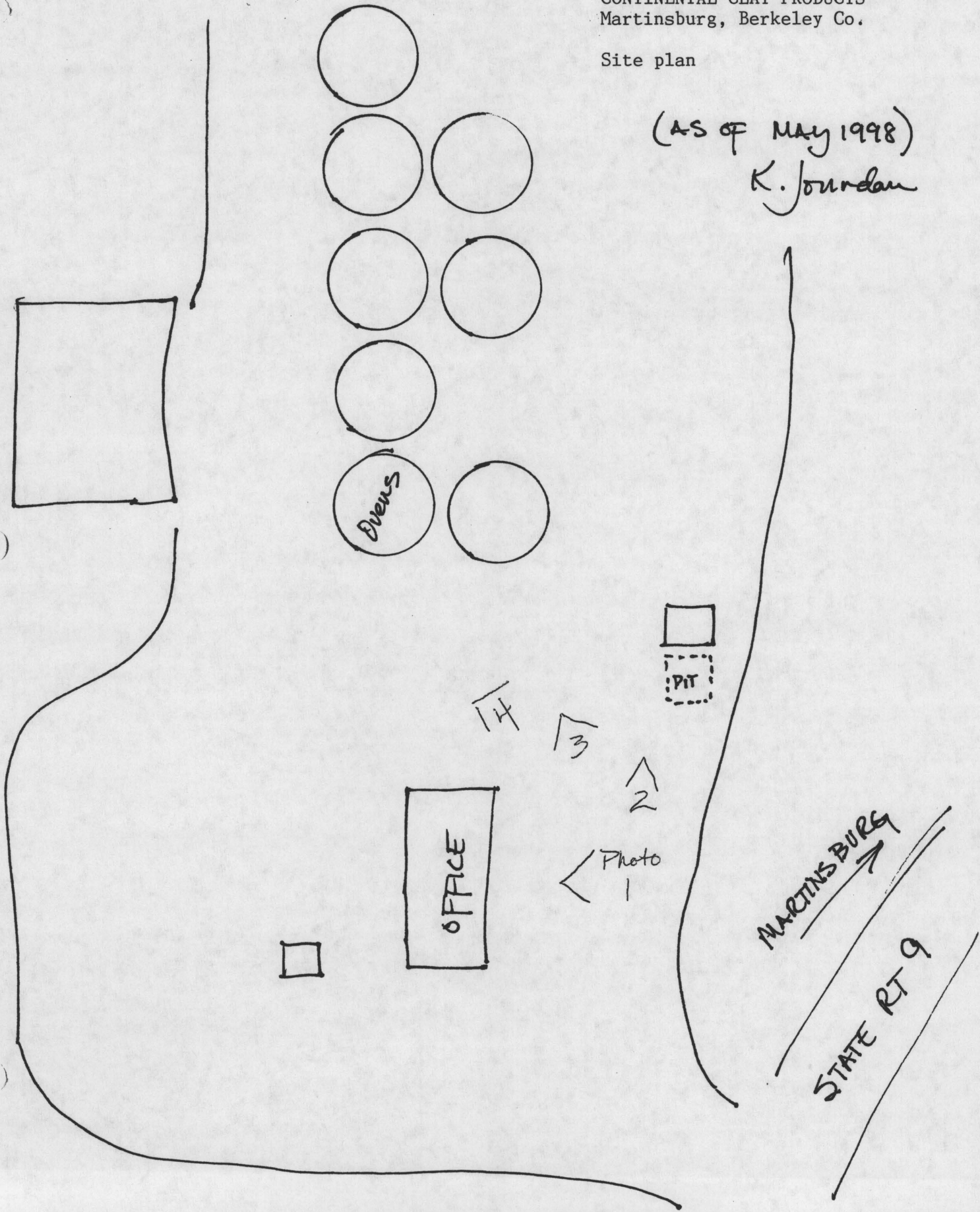

[Send To Printer](#)

[Back To TerraServer](#)

[Change to 11x17 Print Size](#)

[Show Grid Lines](#)

[Change to Landscape](#)

USGS Martinsburg, West Virginia, United States 01 Jul 1979

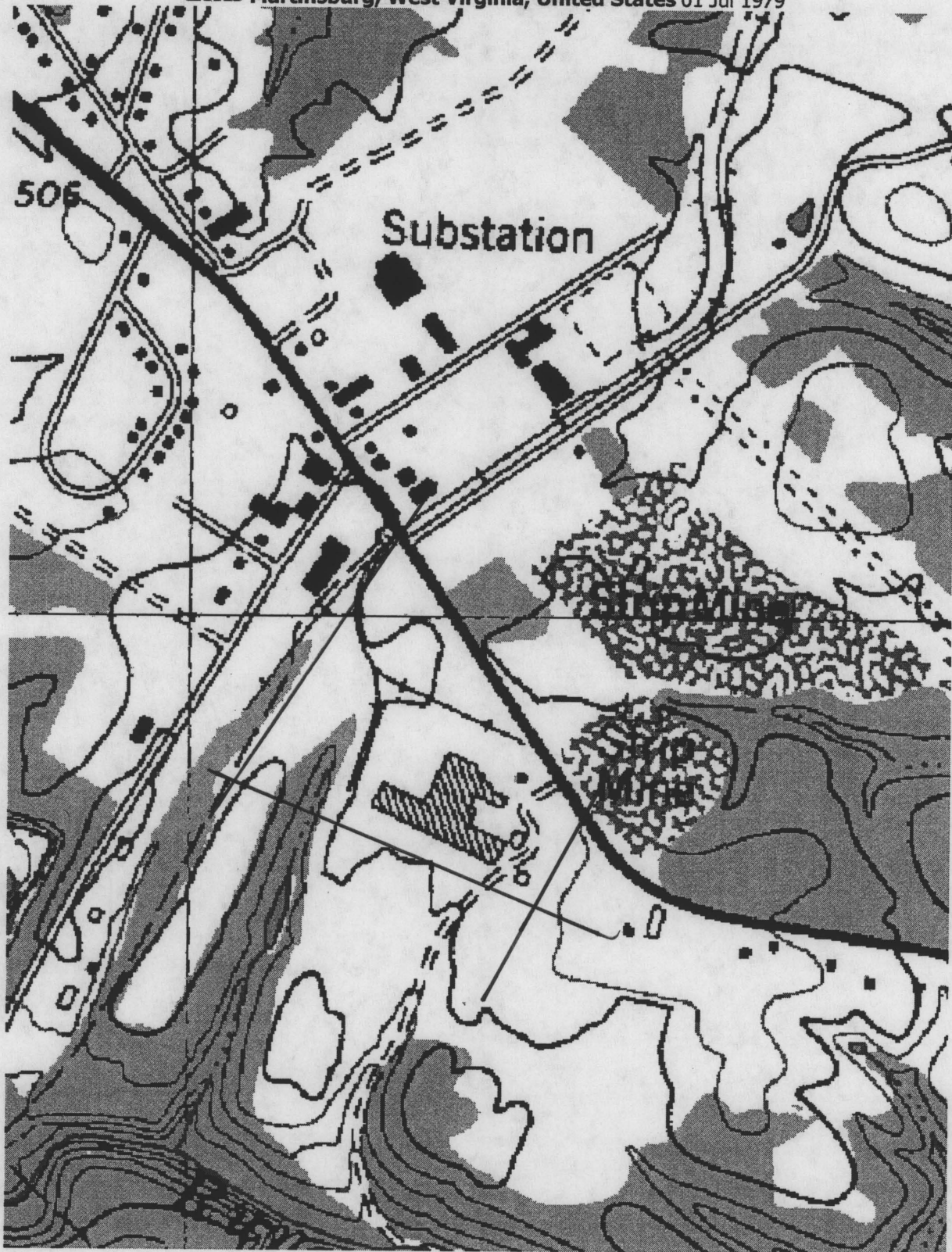

0 200M

0 200yd

Image courtesy of the U.S. Geological Survey
© 2003 Microsoft Corporation. All rights reserved. **Terms of Use**

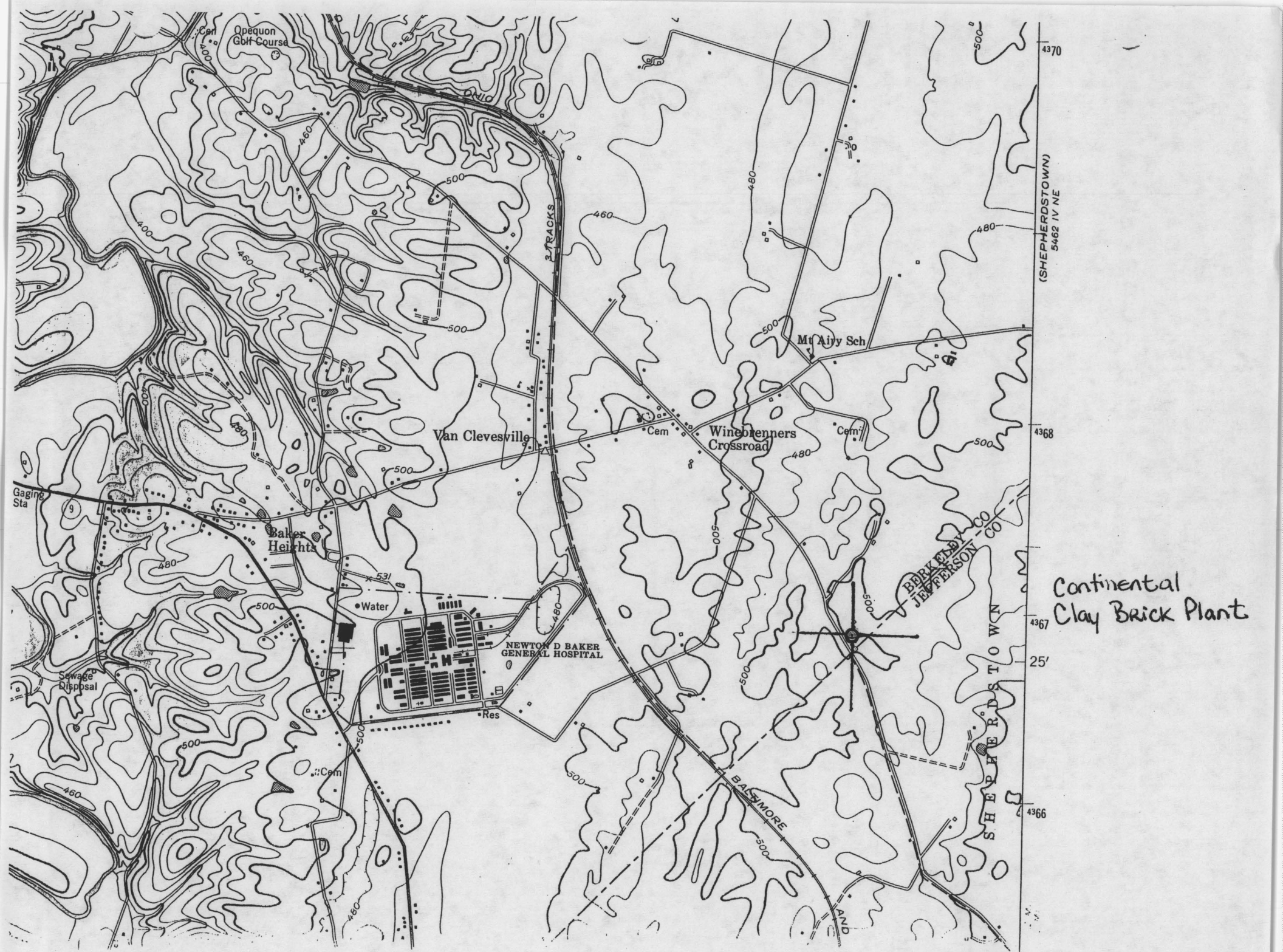

Continental
Clay Brick Plant



