

HISTORIC PRESERVATION UNIT
 DEPARTMENT OF CULTURE & HISTORY
 SCIENCE & CULTURE CENTER
 CHARLESTON, WEST VIRGINIA 25305

File No: 12
 Theme(s):
 Neg No(s):
 USGS Quad:
 UTM Ref: 17/45/580/4346160

DISTRICT . SITE . BUILDING . STRUCTURE . OBJECT

1. NAME(S), historic/common: Citizens National Bank
(Downtown Parkersburg map)
2. LOCATION, street/road: ^{4th} 219 Fourth St. (W corner of 4th & Market Sts.)
TAX MAP- LOT # 92-61 city/town: Parkersburg, WV 26101
 (Incorporated/~~unincorporated~~)

3. USE/FUNCTION, present: offices/ vacant (public/private, restricted)
 original: bank

4. OWNER/ADDRESS, present: William Jacobs (public/private)
 Box 185 Parkersburg, WV 26101
 original: Citizens National Bank

5. PHOTO/SKETCH OF: 8112-R1-F23,25
 8201-R1-F33
 8201-R2-F31
7. PLAN (include approx. dimensions): 51 x 117



6. LOCALE/ENVIRONMENT (map):

8. ACREAGE (approx):

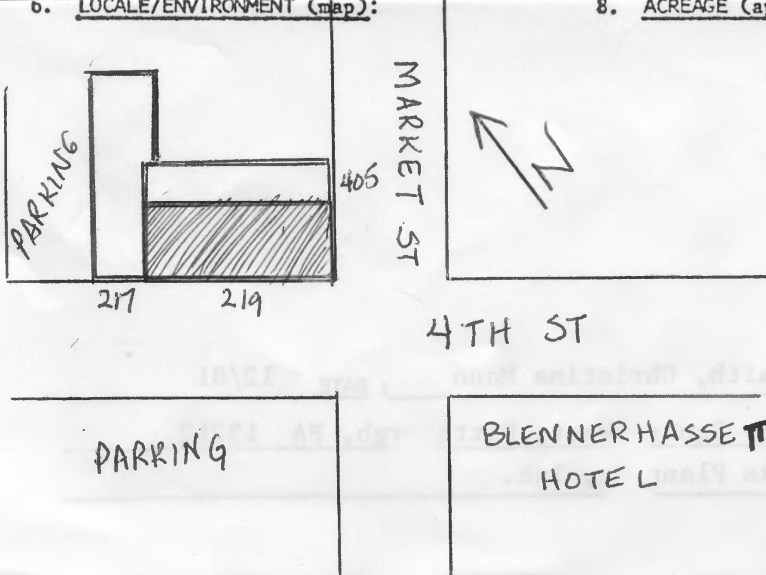

COUNTY: Wood
 Survey Region: _____
 Planning District: _____

BLENNERHASSET
 HOTEL

9. DESCRIPTION (clarify as appropriate): See attached

<p>a. <u>Exterior Fabric</u></p> <p>stone <u>X</u></p> <p>brick <u>mostly</u></p> <p>concrete _____</p> <p>stucco _____</p> <p>weatherboard _____</p> <p>clapboard _____</p> <p>board & batten _____</p> <p>shingle _____</p> <p>other _____</p>	<p>b. <u>Structural System</u></p> <p>masonry <u>X</u></p> <p>frame _____</p> <p>log _____</p> <p>metal _____</p> <p>other _____</p> <p>foundation <u>stone</u></p>	<p>c. <u>Roofing Material</u></p> <p>wood _____</p> <p>metal _____</p> <p>slate _____</p> <p>tile _____</p> <p>asphalt <u>X</u></p> <p>composition _____</p> <p>other _____</p>
--	---	---

<p>d. <u>Associated Structures (use/type):</u></p> <p>outbuildings _____</p> <p>dependencies _____</p> <p>other _____</p>	<p>e. <u>Integrity (include dates):</u></p> <p><u>original site/relocated</u> _____</p> <p>alterations <u>glass block infill</u> on 1st story (SW)</p> <p><u>entirely reworked facade</u> on 1st story (SE);</p> <p><u>removal of arched pediments</u> above central</p> <p><u>arched bays.</u></p> <p>additions _____</p>
---	--

<p>f. <u>Condition:</u></p> <p>excellent _____</p> <p>good <u>X</u></p> <p>fair _____</p> <p>deteriorated _____</p> <p>abandoned _____</p>	<p>g. <u>Threats:</u></p> <p>Unsympathetic alterations.</p>
--	---

10. SIGNIFICANCE (use additional sheet if necessary):

<p>a. <u>Architect/Builder/Engineer:</u> <u>unknown</u></p>	<p>This grand Classical building acts as a crucial cornerstone for the eroding downtown streetscape.</p>
<p>b. <u>Style/Period:</u> <u>Classical</u></p>	
<p>c. <u>Date(s):</u> <u>1898 (datestone)</u></p>	<p>One of the finest professionally designed buildings of the downtown, the old Citizens National Bank forms a strong visual link along Market Street between the B&O underpass and Court Square. While the architect is presently unknown, the building remains a handsome statement of sensitive detail and proportion. Beaux Arts Classicism is here displayed in a combination of arches, applied pressed metal ornamentation, and in the shadows of now-missing hollow metal broken pediments. <u>RE</u></p>

11. BIBLIOGRAPHY:

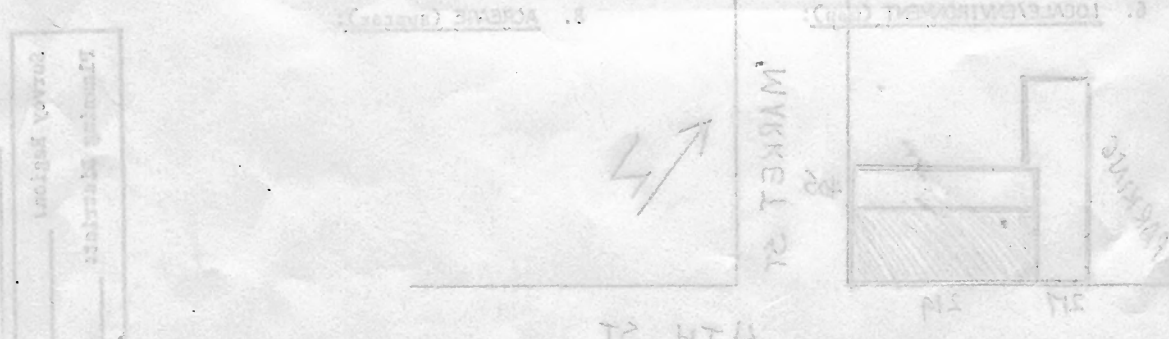

12. FORM PREPARED BY Eliza Smith, Christina Mann ; DATE 12/81

a. Address Allegheny Square West, Pittsburgh, PA 15212

b. Organization Landmarks Planning, Inc.

Citizens National Bank
219 Fourth St. (W corner of 4th & Market Sts.)
92-61

Sited on a commercial lot and flanked by 2 smaller commercial buildings, this 5 story Classical structure measures 3 bays by 1 (9 by 3). It is crowned by a metal rooftop balustrade and a modillion cornice. The 5th story windows, d/s, rest on a sill course/cornice and are separated by recessed panels. The 2nd through 4th stories read as a single colossal system, each bay containing a round arch flanked by two flat arches; the windows are d/s and the spandrels are recessed panels; swags drape above the 4th story windows. On the 1st story, brick pilasters with stone capitals support an entablature; the SW entranceway, the most intact 1st story feature, is arched with flanking engaged columns, banded stonework, and a large foliated cartouche. The corners and bays are defined by quoins; in addition, the central arch on each facade is banded.



Citizens National Bank
110 Fourth St. (W. corner of 4th & Market Sts.)
11-61

Sited on a rectangular lot and flanked by 2 smaller commercial buildings.
This 5 story classical structure measures 7 bays deep (W by E). It is
crowned with a metal roofed balcony and a wide ribbon cornice. The 5th
story windows, 1/2 bay wide on a full bay centerline and are separated by
recessed panels. The 4th through 6th stories rest on a single engaged
column, each bay containing a round arch flanked by two flat arches; the
windows are 1/2 bay wide and the panels are recessed panels; wide drops above
the 4th story windows. On the 1st story, brick pilasters with stone
cornice support an entablature; the 2nd story, the most intact for
any facade, is arched with flanking engaged columns, panelled at lower
and a large foliated cartouche. The cornice and bays are defined by



8112- R1-P23