

HISTORIC PROPERTIES INVENTORY FORM

(Staff Use Only)

HISTORIC PRESERVATION UNIT
DEPARTMENT OF CULTURE & HISTORY
SCIENCE & CULTURE CENTER
CHARLESTON, WEST VIRGINIA 25305

DISTRICT, SITE, BUILDING, STRUCTURE, OBJECT

File No:	22.
Theme(s):	
Neg No(s):	
USGS Quad:	
UTM Ref:	17/451580/4346110

1. NAME(S), historic/common: Blennerhassett Hotel
(Downtown Parkersburg, W.V.)
2. LOCATION, street/road: 316 Market St. (S corner of
TAX MAP-LOT# Market & 4th Sts.)
95-2 city/town: Parkersburg, WV 26101
(incorporated/unincorporated)

3. USE/FUNCTION, present: vacant

(public/private,
restricted)

original: hotel

4. OWNER/ADDRESS, present: Keltner, Robert E.
Inmate, West Virginia State Penitentiary
Moundsville, W.Va.
original:

(public/private)

5. PHOTO/SKETCH OF: 8112-R1-F14, 18-22
8201-R1-F9-11, 34-36, R2-F1, 32

7. PLAN (include approx. dimensions):



6. LOCALE/ENVIRONMENT (map):

8. ACREAGE (approx): 150' by 100'
City Lot No. 95-2
(See No. 2)

COUNTY: Wood

Survey Region: _____

Planning District: _____

FOURTH ST

PARKING

MARKET ST

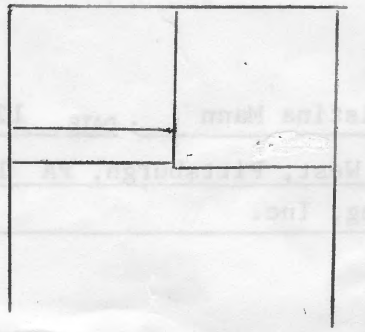

9. DESCRIPTION (clarify as appropriate): See attached

a. Exterior Fabric

stone _____
 brick painted _____
 concrete _____
 stucco _____
 weatherboard _____
 clapboard _____
 board & batten _____
 shingle _____
 other _____

b. Structural System

masonry X _____
 frame _____
 log _____
 metal _____
 other _____
 foundation _____

c. Roofing Material

wood _____
 metal _____
 slate X _____
 tile _____
 asphalt _____
 composition _____
 other _____

d. Associated Structures (use/type):

outbuildings _____

 dependencies _____

 other _____

e. Integrity (include dates):

original site/relocated _____
 alterations 1st floor altered
all around _____
 additions _____

f. Condition:

excellent _____
 good X or _____
 fair X _____
 deteriorated _____
 abandoned _____

g. Threats:

Currently vacant except for one 1st story restaurant, the building faces some threat of demolition until a new use for it is devised.

10. SIGNIFICANCE (use additional sheet if necessary):

a. Architect/Builder/Engineer:

not known

b. Style/Period: Queen Anne

c. Date(s): 1889

Once Parkersburg's premier hotel (of 11 in 1898) serving railroad and traveling men, then Blennerhassett has seen a decline in the city's commercial prowess and a corresponding decline in its own stature. Until recent years, it was a residential hotel. The building suffered a fire in 1978. Now it is vacant.

The picturesque silhouette and fine detailing of the Blennerhassett nonetheless make it one of the major visual elements of the downtown streetscape. Faced with the possibility of demolition, the building warrants study for adaptive use.

11. BIBLIOGRAPHY:

1908 United Commercial Travelers.

"Social Life Many Years Ago in Parkersburg is Described," The Sentinel, June 1939 (Anniversary Edition).

Miss Frances Inslee, interview, Dec. 9, 1981.

12. FORM PREPARED BY Eliza Smith, Christina Mann, DATE 12/81

a. Address Allegheny Square West, Pittsburgh, PA 15212

b. Organization Landmarks Planning, Inc.

Blennerhassett Hotel

316 Market St. (S corner of Market & 4th Sts.)

95-2(&3?)

Sited on a prominent corner at the heart of downtown Parkersburg, this 4 story, attached structure presents a highly textured and picturesque silhouette to the streetscape; the southernmost bay on Market St. rises 5 stories. Its asymmetrical composition measures roughly 4 bays square; buttresses define the bays. The roof includes a mansard on the 2 street facades, pierced by Chateausque dormers, a chimney (NE), a flattened gable (NE), and a standard gable (NW); at the corner is a taller, round, conical roofed tower with a finial; ornament throughout the roofline includes a corbeled cornice and brick and terra cotta work. The 3rd and some of the 4th story windows, generally grouped 2 per bay, are d/s with arched lunettes; the raised brickwork of the arches continues as a springing course, interrupted only by the buttresses. The 2nd story windows are d/s with straight transoms; drip molding in a similar raised brickwork frames the pairs. The 1st story has been remodeled with various facing materials and an Art Deco corner entrance.



Blennhassett Hotel
315 Market St. (S. corner of Market & 4th Sts.)
95-25237

Sited on a prominent corner at the heart of downtown Portland, this 4-story attached structure presents a highly textured and picturesque silhouette to the streetscape. The southernmost bay on Market St. rises 3 stories. Its asymmetrical composition features a row of 3 bays square; buttresses define the bays. The roof includes a mansard on the 2nd story facade, flanked by a chimney (NW), a chimney (NE), a flat roof (SE), and a standard gable (SW). At the corner is a taller round, conical roofed tower with a spiral ornament throughout the roofline including a corbelled cornice and brick and terra cotta work. The 3rd and some of the 4th story windows, generally grouped 2 per bay, are also with arched lintels. The raised brickwork of the 4th story continues as a swinging course, interrupted only by the buttresses. The 5th story windows are also with arched transoms; drip molding in a similar raised brickwork defines the eaves. The 1st story has been remodelled with various



8201-R2-F35